

PAC

International



NOISE
CONTROL
SOLUTIONS



REAL SOLUTIONS IN CONSTRUCTION

2025
USA/CA



**WELCOME TO
PAC INTERNATIONAL**

**We specialize in
manufacturing high-
performance noise-control
products for building
construction**

**PAC International
offers extensive
expertise in acoustics,
fire, and construction to
provide real solutions in
construction**

RSIC-1®

Included in over 185 UL
fire-resistive designs

NOW IN HIGH VIS. RED



THE ORIGINAL
RESILIENT SOUND ISOLATION CLIP

THE ORIGINAL SOUND ISOLATION CLIP



The RSIC-1 now in High Vis Red, makes it easy to verify you have the original sound isolation clip. Included in more UL fire-resistive design assemblies than any other clip. It can be used on walls and ceilings. With over 24 years of testing, PAC has an extensive database of tests, including standard and many unique assemblies. It's long been established that the RSIC-1 provides high levels of sound isolation on single-stud walls, and it's the preferred choice of acoustical consultants. However, it's not just single-stud walls. Even on double-stud walls, the RSIC-1 can be essential to achieving the desired sound isolation.

APPLICATIONS

Condo Buildings

Retail Spaces

Recording Studios

Home Theaters

Commercial Spaces

Apartment Buildings

Conference Rooms

Commercial Theaters

TYPES OF SYSTEMS



WOOD



STEEL



CMU



CONCRETE

SPECIFICATIONS

Acoustical Design Load	36 Lbs
Total Deflection	3 mm
Cavity Depth	1 5/8"
Low VOC Tested	Yes
Use in Ceilings	Yes
Use in Walls	Yes
Use in New Construction	Yes
Use in Retrofit	Yes

WALLS

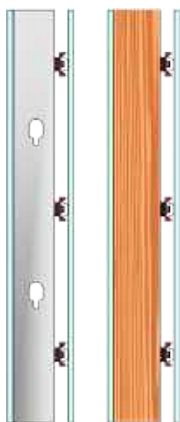

CEILING

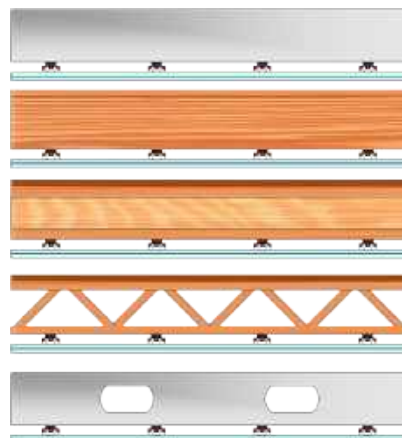

Are you sure you're getting the genuine RSIC-1® on your project?

Why are the RSIC-1 clips now in High Vis. Red? PAC International has become aware of several unauthorized companies selling counterfeit clips under the RSIC®, RSIC-1®, and Resilient Sound Isolation Clip® names which are all protected under US registered trademarks. There are, of course, many authorized distributors of PAC's products, and you can find them on our website. These distributors have been great partners over the years, and they are NOT who we're talking about. We are talking about companies selling products that look like the RSIC-1 using the RSIC or Resilient Sound Isolation Clip name, but that are not manufactured or supported by PAC. These look alike products do not have the same acoustical performance or fire ratings.



Counterfeit or look-alike products may NOT possess the genuine features the RSIC-1® offers

When you buy a genuine RSIC-1®, you will get:

- The ORIGINAL resilient sound isolation clip
- 20+ years of experience and installations
- Backed by hundreds of acoustical tests
- Over 185 UL fire-resistive designs
- Direct support from experts in acoustics, fire, & construction
- Full QA program including an in-depth inspection and testing procedure to test for quality, strength, and performance
- Load tests to show the product meets or exceeds code-required safety
- VOC testing to ensure compliance with CFHP standards for classrooms and offices

PAC International is implementing a new quality assurance program to help ensure that genuine RSIC-1® clips are installed on a project. When RSIC clips are delivered to the job site, each box of clips will come with a QR code that can be used to register the project and notify the building official of the product used on this project. Registering the project will verify that genuine RSIC-1 clips have been delivered and installed. This innovative program offers verification for acoustical engineers, architects, and building officials alike. You can request information from your on-site installer and register it yourself or have them do it for you.

Example of the new QA Stickers

RSIC-1® QA Sticker "At Clip"

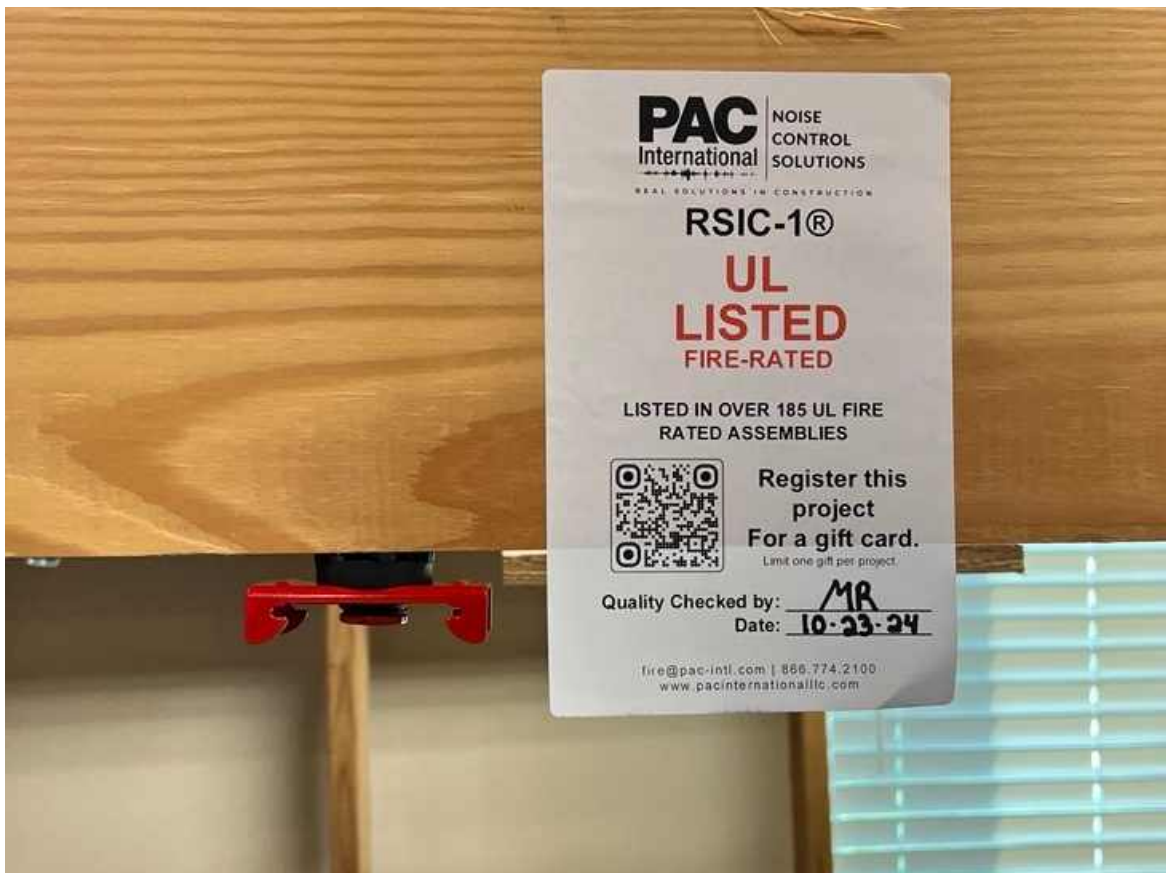

FORMULA ONE PADDOCK

LAS VEGAS, NEVADA



PRODUCT

RSIC-1®



OVERVIEW

The Formula One Paddock in Las Vegas, Nevada, benefited from the installation of PAC RSIC-1 sound isolation clips. Positioned within the walls and ceilings above the paddock garages, these clips served to effectively mitigate noise and vibrations, ensuring a quieter and more comfortable experience for the suites located above.

PROJECT DETAILS

300,000 sq ft paddock building, modern pit buildings equipped with 13 team garages, hospitality suites, media centers, premium bars, and administrative offices. The paddock area provided space for team trailers, equipment storage, and support facilities

DISTRIBUTOR

L&W Supply

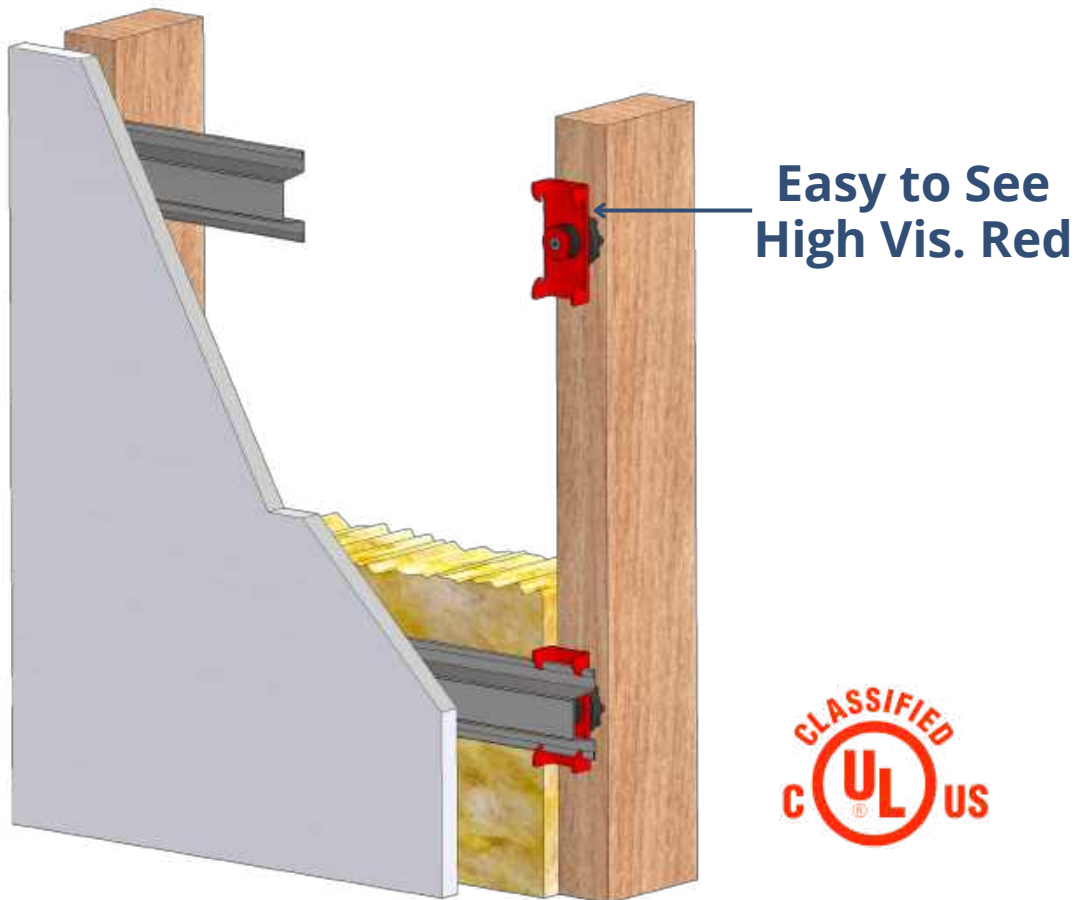

Reliable performance



Outperforms resilient channel



Included in over 185 UL fire-resistive designs



In stock & shipping now



RSIC® Backer & RSIC® Backer HD



**HEAVY DUTY MOUNT FOR USE
WITH RSIC-1 SYSTEMS**

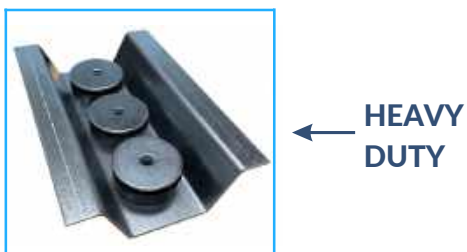
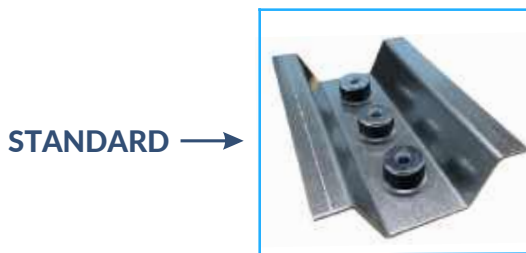

HEAVY DUTY MOUNT FOR RSIC® SYSTEMS

The RSIC Backers are acoustically isolated backers for mounting heavy objects in conjunction with the RSIC-1 or RSIC-V sound isolation clips. The RSIC Backers aid in eliminating a common problem with short circuits within your wall assembly. Without the RSIC Backers, the acoustical performance of the wall is degraded when heavy items are mounted directly to the structure. These products can be used in various applications where extra support is required, including cabinets, chalkboards, projector screens, TV wall mounts, shelving, lockers, speakers, and many more.

APPLICATIONS

Cabinets

Chalkboards

Lockers

Shelving Units

Projector Screens

TV Wall Mounts

Speaker Systems

Home Theaters

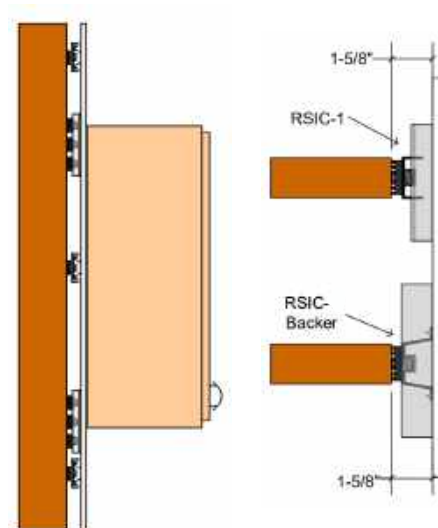

SPECIFICATIONS

Acoustical Design Load	108 Lbs - 216 Lbs
Total Deflection	3 mm
Cavity Depth	1 5/8"
Use in Walls	Yes
Use in Ceilings	Yes
Use in Retrofit	Yes
Use in New Construction	Yes

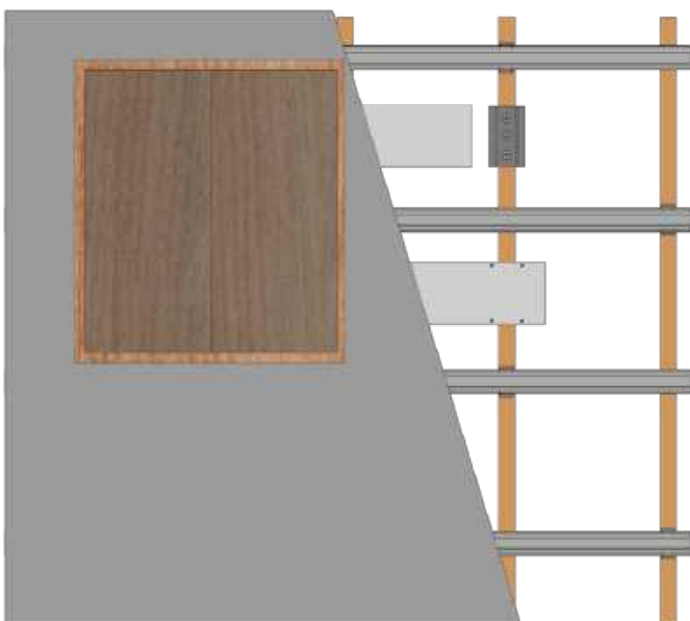

RSIC-1® BACKER

- Acoustically isolated backers for mounting heavy objects in conjunction with the RSIC-1® sound isolation clips
- Eliminates a common problem with short circuits within your wall assembly
- Maintains the acoustical performance of the wall when mounting heavy items



For use with: cabinets, chalkboards, projector screens, TV wall mounts, shelving, lockers, speakers, etc.

RSIC-1® Backer

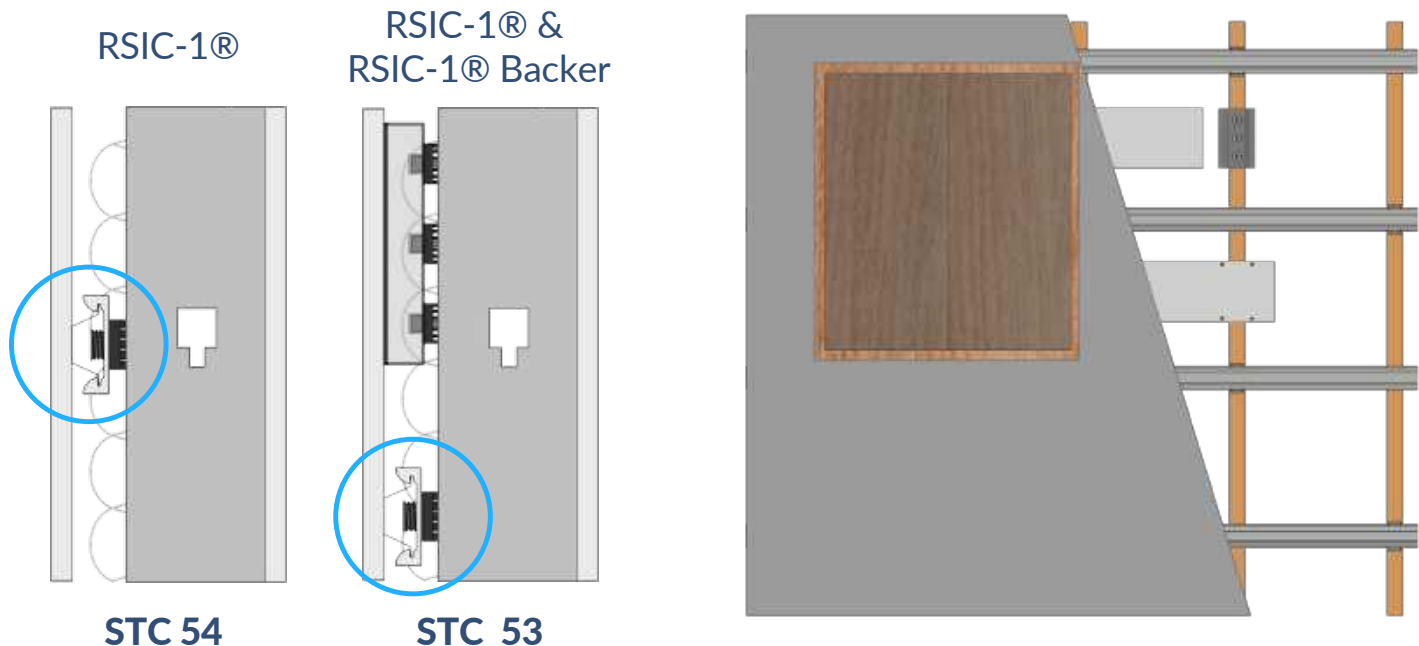

RSIC®-V BACKER

- Acoustically isolated backers for mounting heavy objects in conjunction with the RSIC®-V sound isolation clips
- Eliminates a common problem with short circuits within your wall assembly
- Maintains the acoustical performance of the wall when mounting heavy items



For use with: cabinets, chalkboards, projector screens, TV wall mounts, shelving, lockers, speakers, etc.

RSIC®-V Backer

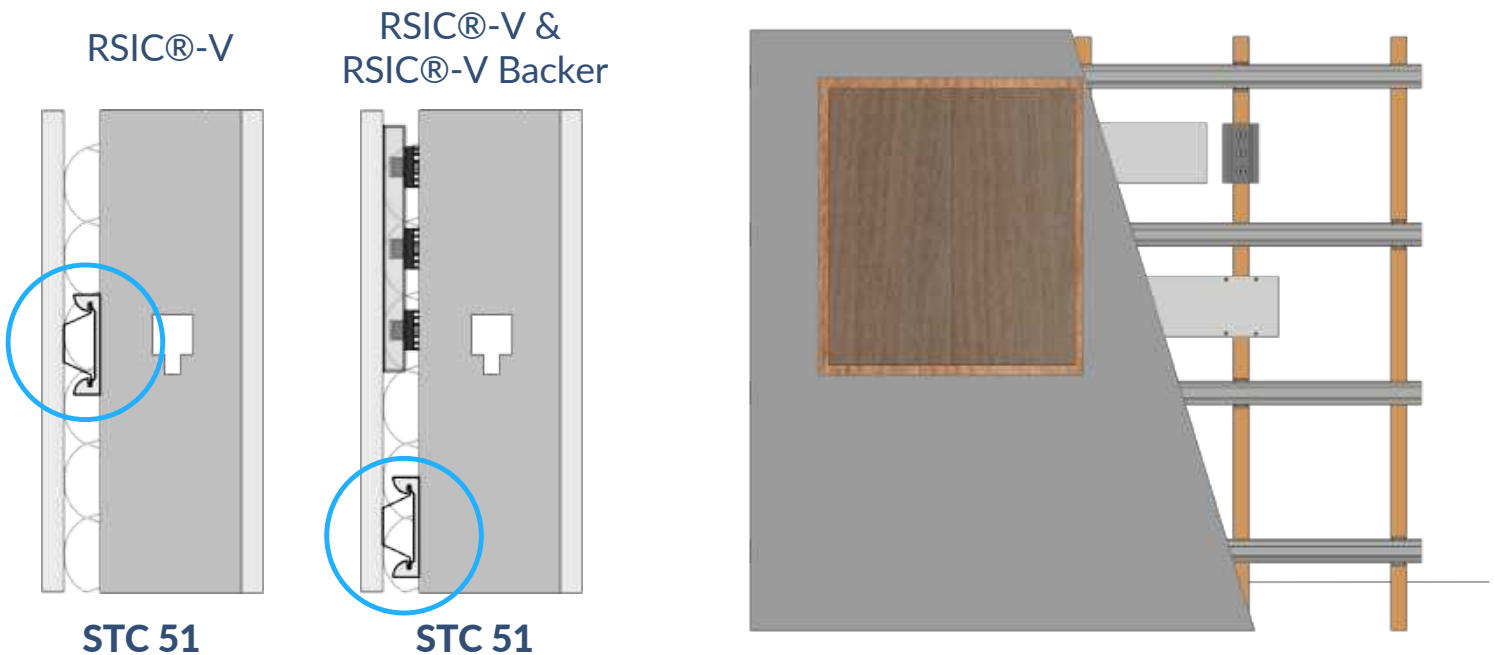

TL RESIDENCES

SAN FRANCISCO, CA



PRODUCT

RSIC® BACKER



OVERVIEW

The RSIC Backer found its place as an acoustically isolated backer system within the TL Residences in San Francisco, California. Installed throughout the residences, its purpose was to uphold the acoustical performance of the wall system while also allowing for the safe installation of flat-screen TVs and Murphy beds in certain units.

PROJECT DETAILS

240 micro-unit apartment home community, 3,000 SF of retail, LEED gold standards, and units approximately 230 to 280 square feet

DISTRIBUTOR

L&W Supply



Eliminates short-circuits common when mounting heavy items on acoustically isolated walls



Necessary to maintain the acoustical performance of RSIC systems when mounting heavy items



Included in all UL assemblies where the RSIC-1 and RSIC-V are listed



Acoustically tested to maintain acoustical performance

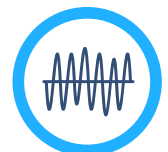

RC-1 Boost®



**SAVE MONEY,
BOOST PERFORMANCE**

BOOST IIC RATINGS BY 5 POINTS!

RC-1 Boost is the most cost-effective way to improve the IIC rating of common floor/ceiling assemblies with resilient channels.

PAC's testing shows that adding the RC-1 Boost can consistently provide a 5-point increase in the IIC rating of assemblies with resilient channels. This makes the RC-1 Boost a less expensive and more effective means of improving IIC ratings when compared with the typical methods of adding batt insulation or gypsum board layers.

RC-1 Boost can be used to make the acoustical performance of other resilient channels match or exceed that of RC-Deluxe. This provides many alternatives to RC-Deluxe to allow for more competitive bidding, and it provides a solution for times when RC-Deluxe is specified but another type of channel is sent to the job site.

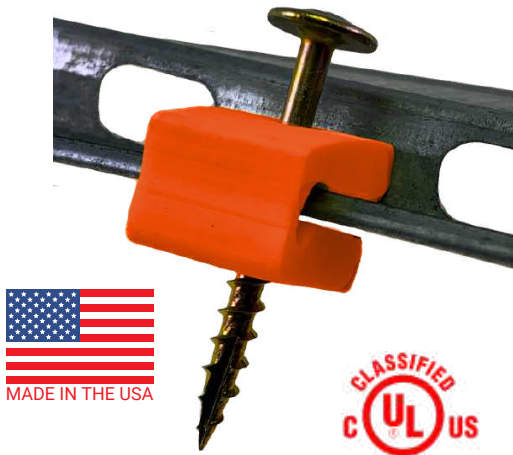

WALLS

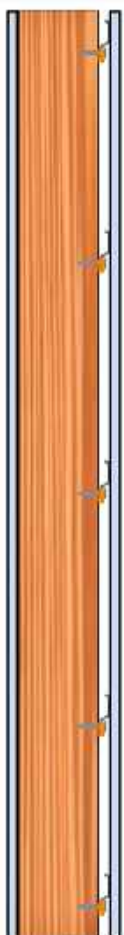

CEILINGS

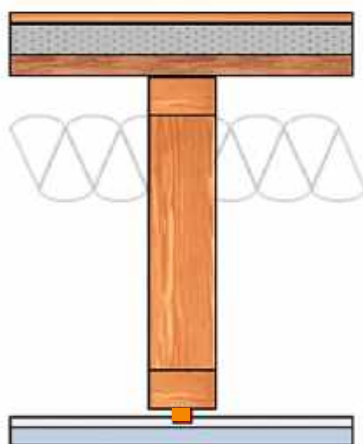
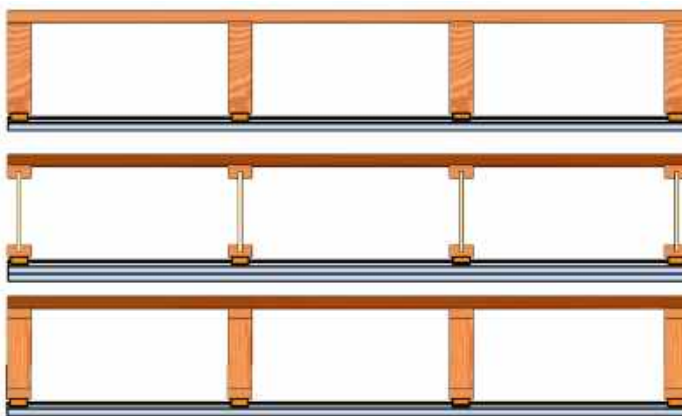

APPLICATIONS

Multi-family Housing

SPECIFICATIONS

Acoustical Design Load	Up to 18 Lbs
Cavity Depth	3/4"
Use in Ceilings	Yes
Use in Walls	Yes
Use in New Construction	Yes
Made in USA	Yes

THE MOST ECONOMICAL WAY TO IMPROVE ACOUSTICAL PERFORMANCE

Base Assembly

PAC
International

L2271.24 (Intertek)

CONSTRUCTION

- Kahrs Linnea Wood Flooring Floated
- Ecore QT4002 2mm Rubber Underlayment Floated
- 3/4" (19mm) Gypsum Concrete Topping
- 3/4" (19mm) OSB
- 18" (457mm) Open Web Truss @ 24" oc. (610mm)
- 3-1/2" (89mm) R-13 Fiberglass Insulation
- ClarkDietrich RC-Deluxe @ 16" oc. (406mm)
- 1 Layer 5/8" (16mm) Firecode "C" Gypsum Board

STC: 59 IIC: 55 HIIC: 63

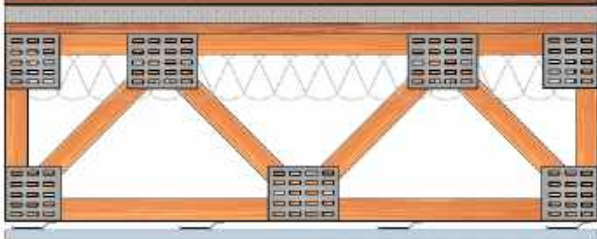

RC-1 Boost + 5 IIC Points

IIC
60

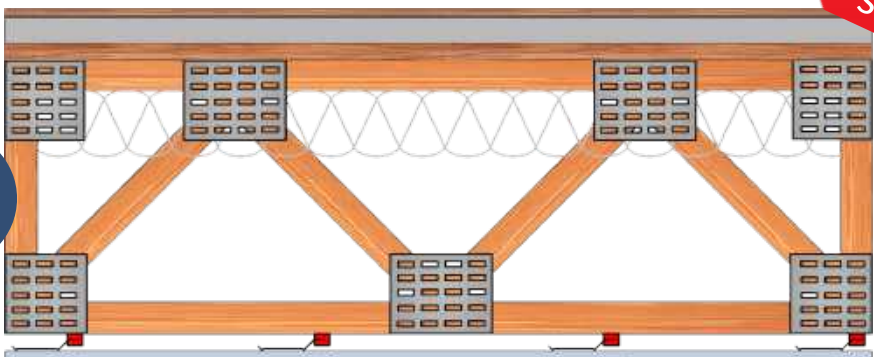

• +\$0.18/
sqft

More Gyp + 2 IIC Points

IIC
57

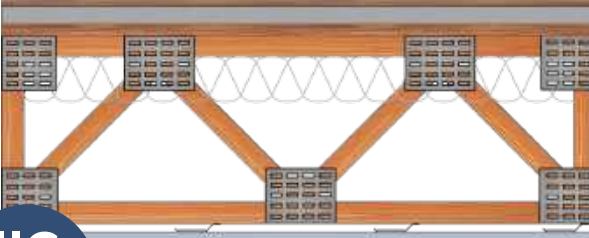

• +\$0.47/
sqft

More Batt + 3 IIC Points

IIC
58

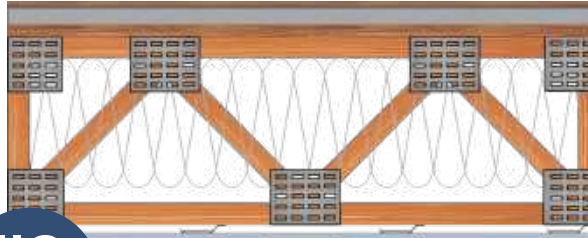

• +\$0.62/
sqft

**THE PRESERVE AT
WESTFEILD (PHASE 2)
NORTHWOOD RAVEN**
CHANTILLY, VIRGINIA



PRODUCT



OVERVIEW

PAC has been implemented in Prose Broadstone Baybrook, situated in Webster, Texas. Specifically, the RC-1 Boost® sound isolation clip product has been utilized to decouple the Generic RC-1 channel from the framing. This enhances the acoustical performance of the RC-1 channel, further optimizing its effectiveness in sound isolation.

PROJECT DETAILS

283 Luxury apartments with unique designs, studio, one, two-, and three-bedrooms apartments. Pool and fitness center, large indoor spa, and residential clubroom.

DISTRIBUTOR

Eastern Applicators



ABOUT RC-1 BOOST®

The RC-1 Boost was designed to work with all RC to improve its acoustical performance. PAC's extensive laboratory testing shows that the RC-1 Boost consistently improves the acoustical performance of alternative RC so that it meets or exceeds the performance of the premium RC without Boost. Specifically, the RC-1 Boost consistently added five IIC points for all the RC makes and models PAC tested.

CHALLENGE/SOLUTION #1

When the contractor went to get the proprietary resilient channel specified for the project, it was unavailable. The contractor reached out to the project team for suitable alternatives and Nick Block (SLR Consulting), the project's acoustical consultant, recommended using PAC's RC-1 Boost with the available resilient channel to keep the project moving while maintaining the project's acoustical performance goals.

CHALLENGE/SOLUTION #2

During the first building inspection after the installation of the RC-1 Boost the building inspector questioned the use of the RC-1 Boost with the lightweight gypsum board used on the project. The issue arose from the inspector's narrow and strict interpretation of the relatively new UL design for the project's floor/ceiling assembly. Crescent Communities immediately reached out to PAC for assistance, and we worked directly with UL to provide the documentation the inspector needed to approve the assembly design.



"Resilient channel product availability has created issues on numerous projects over the past year. PAC International was able to provide a solution with the RC-1 Boost that exceeded the performance of the originally specified resilient channel when installed with the available lower performing resilient channels."

Nick Block

Senior Engineer at SLR Consulting

RC-1 BOOST



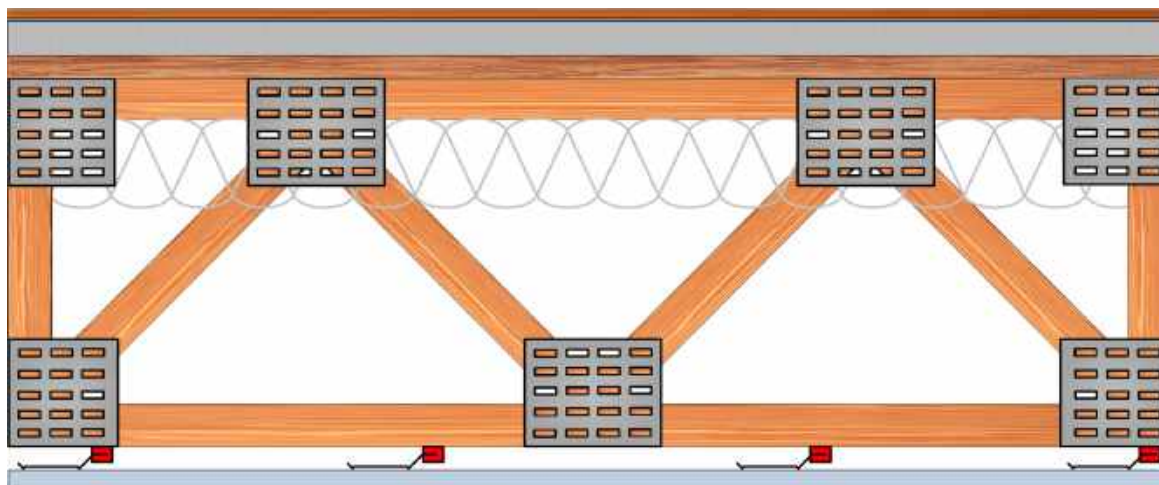

Improves performance of all resilient channel



Most cost-effective IIC improvement



Alleviates supply issues with premium resilient channels



Included in over 79 UL fire-resistive designs



RSIC-1® ADM



**MAXIMUM ACOUSTICAL PERFORMANCE
WITH MINIMAL CEILING DROP**

LABOR SAVING ADJUSTABLE CEILING MOUNT

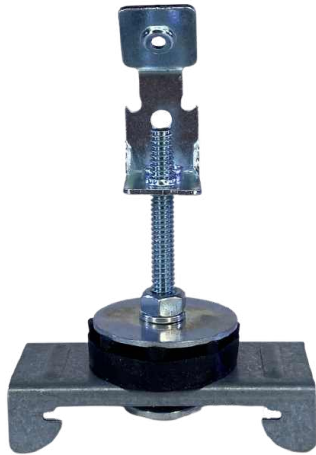

PAC's RSIC-1 ADM is the perfect solution for areas where you need high levels of sound isolation and space is at a premium. It can be shot into the bottom of concrete slabs and composite decks for quick and easy installation. The RSIC-1 ADM can be installed with plenum depths as small as 2-5/8". It's a great alternative to springs for condominiums, gyms, amenity spaces, generator rooms, and retail spaces below living units.

The RSIC-1 ADM Multi Clip attaches directly to the bottom of the framing or concrete or the side of a wood or steel joist, decoupling the gypsum board from the structure and reducing sound transfer between spaces.

APPLICATIONS

Mechanical Rooms

Apartment Buildings

Recording Studios

Condo Buildings

Retail Spaces

Conference Rooms

Commercial Theaters

Mixed-Use Spaces

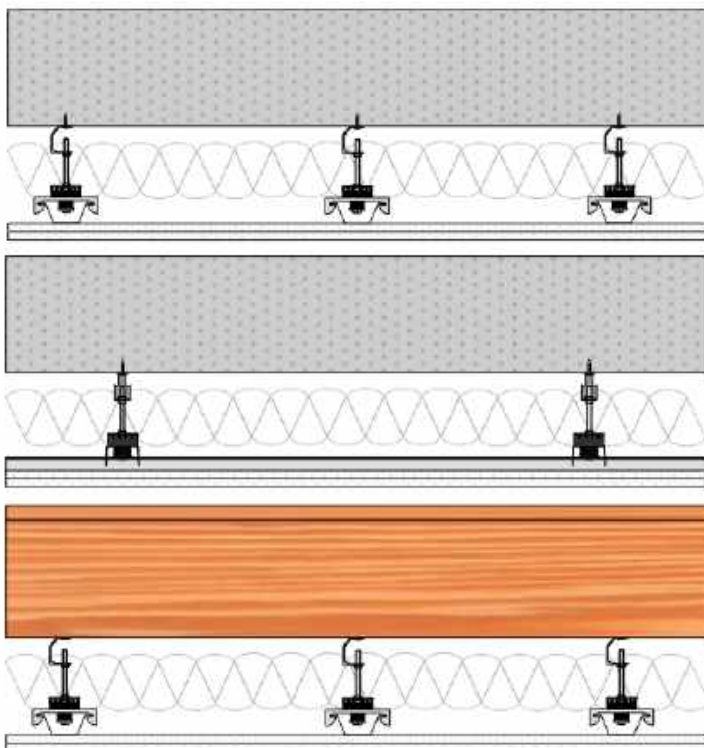

SPECIFICATIONS

Acoustical Design Load	36 Lbs
Total Deflection	3 mm
Adjustable	Yes
Cavity Minimum	2-5/8"
Cavity Maximum	Up to 12"
Low VOC Tested	Yes
Use in Ceilings	Yes
Use in Walls	No
Use in New Construction	Yes
Use in Retrofit	Yes

**ASTON MARTIN
RESIDENCES**
MIAMI, FLORIDA



PRODUCT

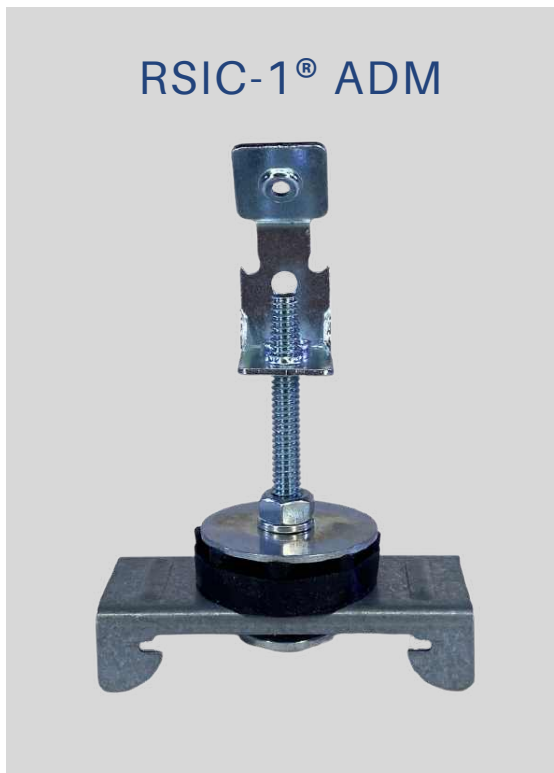

DISTRIBUTOR

Voyce-Legier

OVERVIEW

The RSIC-1 ADM was used in the Aston Martin Residences in Miami, Florida. The RSIC-1 ADM was used for the ceilings to acoustically isolate the amenity space from each other and from the residences below the amenity areas. PAC's products were specified to meet the exacting standards and high expectations of the Aston Martin Residences.

PROJECT DETAILS

391 condominiums, 66 floors, 1 to 5-bedroom residences, duplexes, penthouses, and triple penthouses.

Level 52: Art gallery, Business center, Conference room, Kids playroom, teen center, game room, and Vending area

Level 53: Fitness and spa lounge, Spa, Fitness center, Spinning room, Boxing room, Treatment suites, Sauna, Meditation room, Beauty salon, and Barbershop

Level 54: Fitness center, Virtual golf, and two movie theaters

Level 55: Infinity Pool, Pool deck, Pool cabanas, Sky bar/lounge, Pool concierge, Chef's kitchen, and Private dining room

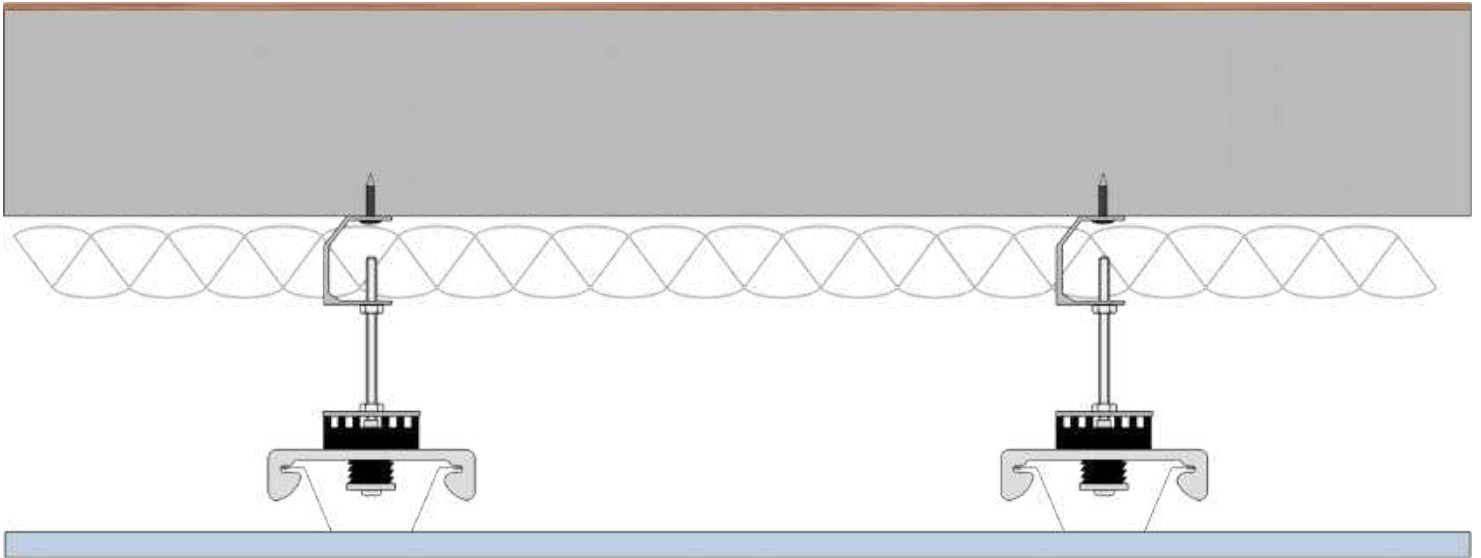

A lower-cost alternative to standard spring hangers



Can be “shot in” to concrete decks for fast and easy installation



Maximum acoustical performance with minimum ceiling drop



PAC-RCB

PATENTED



WALL MOUNT ISOLATION
FOR HEAVY OBJECTS

ELIMINATES SHORT-CIRCUITS CAUSED BY MOUNTING HEAVY OBJECTS ON WALLS WITH RESILIENT CHANNEL



The PAC-RCB is designed for use with all resilient channel wall systems where support for heavy loads like cabinets, bookshelves, headboards, shelving, etc., is required. The PAC-Resilient Channel Backer (RCB) is a simple yet effective solution that works on wood and steel studs of all sizes and spacings.

The PAC-RCB mounts directly to the face of a stud and provides the proper offset so that the horizontal backer is flush with the resilient channel when installed. Backers can either be nominally 2" thick wood (2x4, 2x6, etc.) or steel box beams formed of steel track and studs. The backer is decoupled from the PAC-RCB bracket using PAC's proprietary rubber isolators and specially designed screws.

TYPES OF SYSTEMS

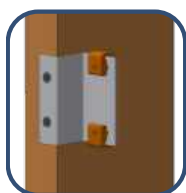

WOOD

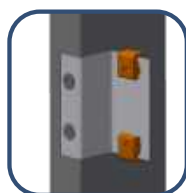

STEEL

EXAMPLE

DOES NOT MEET CODE MINIMUM

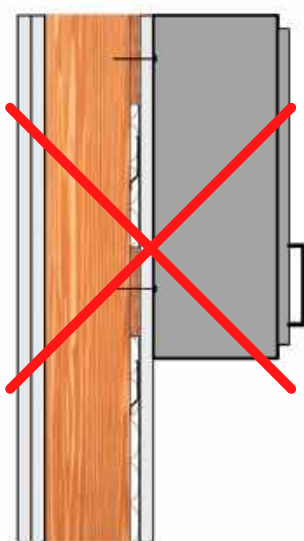

Base Wall + Cabinets & Plywood Backing

EXCEEDS CODE MINIMUM

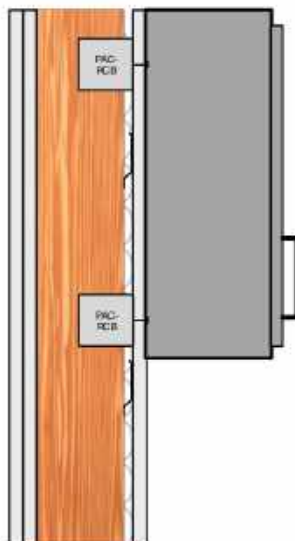

Base Wall + Cabinets & PAC-RCB

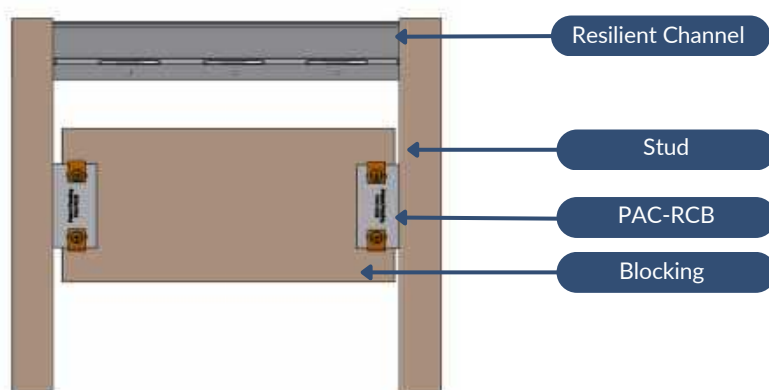

SPECIFICATIONS

Acoustical Design Load (ADL)	Up to 25 Lbs Each
Combined ADL	50 Lbs Per Set
Cavity Depth (from face of stud)	1/2"
Use in Walls	Yes
Use in Ceilings	Yes
Use in New Construction	Yes
Assembled in USA	Yes

MONROE APARTMENTS MILWAUKIE, OREGON



PRODUCT



OVERVIEW

The PAC-RCBs found their place in the newly constructed Monroe Apartments in Milwaukie, Oregon. Specifically selected by the acoustical consultants for the project, these PAC-RCBs were instrumental in preserving the acoustical performance of the walls, especially when mounting cabinets and other heavy items.

PROJECT DETAILS

234 apartments; studio, one-, two-, & three-bedroom units and live/work units, 495-1,198 square feet. clubhouse with kitchen, lounge, conference room, fitness center, and yoga studio.

DISTRIBUTOR

GTS Interior Supply

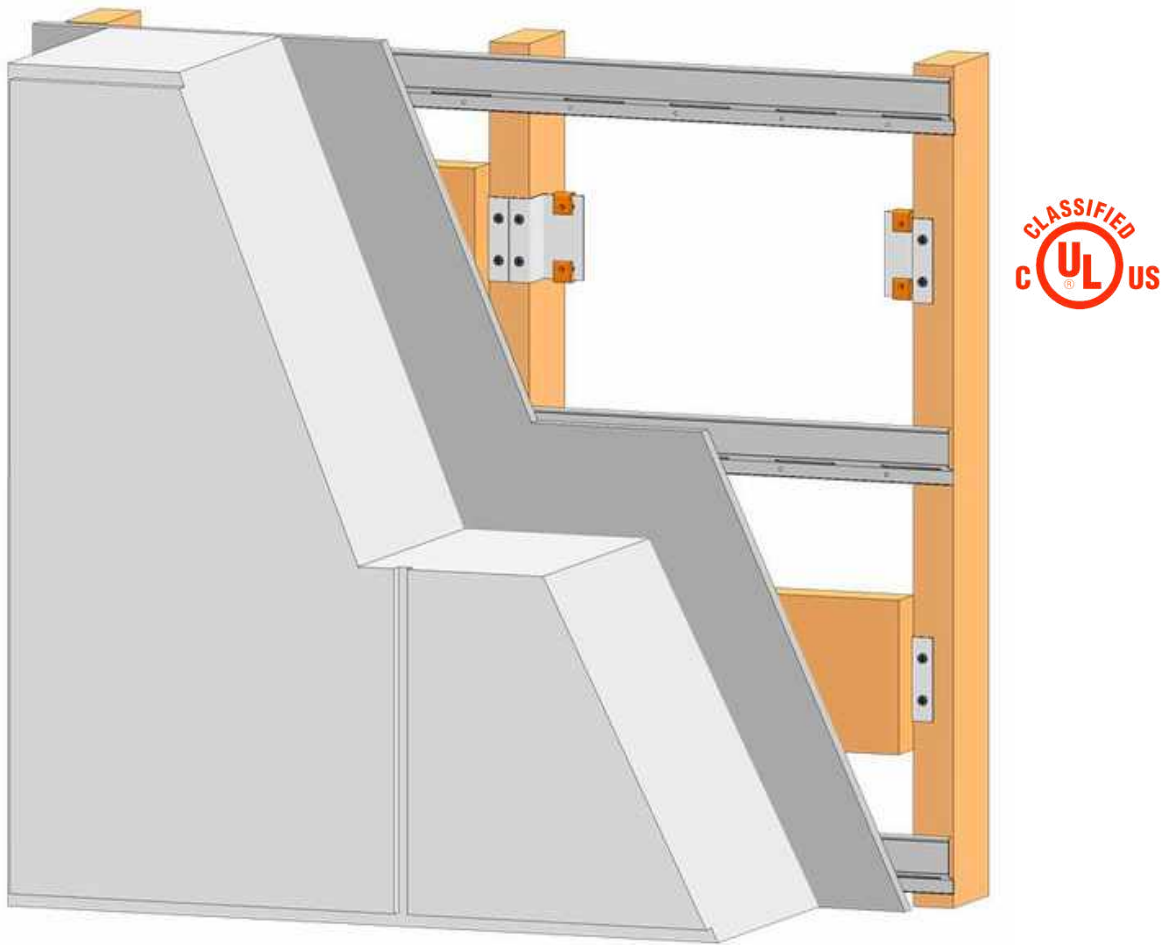

Eliminates short-circuits caused by mounting heavy objects on walls with resilient channel



Tested to maintain the acoustical performance of the base wall



Options available for resilient channel with and without PAC RC-1 Boost



Included in all UL assemblies where the RSIC-1 and RSIC-V are listed



RSIC®-SI-X



**INNOVATIVE, LOW-PROFILE
SPRING ISOLATOR**

THE NEXT GENERATION OF SOUND ISOLATION

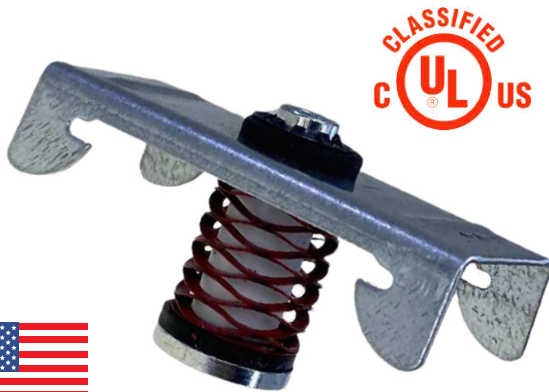

PAC's RSIC-SI-X is a new patented low-profile spring isolator that provides superior low-frequency isolation compared to typical rubber sound isolation clips.

The RSIC-SI-X is designed for faster and easier installation compared to industry-standard 1" deflection springs because it attaches directly to the underside of the structure and requires no additional backing. With an acoustical design load ranging from 7 lbs. to 26 lbs. per isolator, the RSIC-SI-X clip can support up to two layers of 5/8" gypsum board with spacing at 16" x 48" on center.

LOAD OPTIONS



White
7 Lbs

Blue
13 Lbs

Red
26 Lbs

APPLICATIONS

- Commercial Spaces
- Apartment Buildings
- Conference Rooms
- Theaters

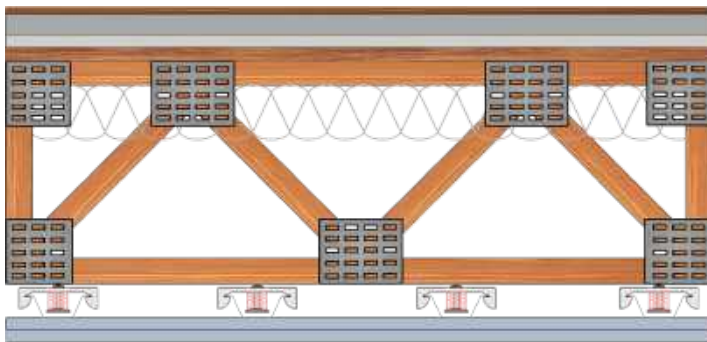

TYPES OF SYSTEMS

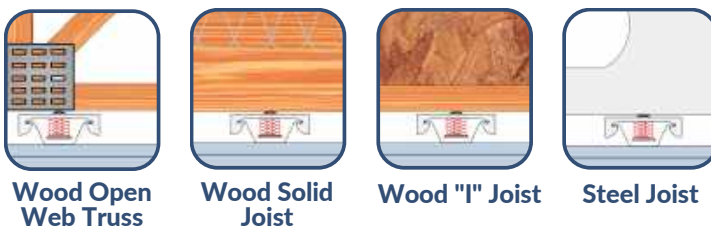

Wood Open Web Truss

Wood Solid Joist

Wood "I" Joist

Steel Joist

SPECIFICATIONS

Acoustical Design Load	7-26 Lbs
Total Deflection	0.38"
Cavity Depth	1 7/8"
Use in Ceilings	Yes
Use in New Construction	Yes
Use in Retrofit	Yes
Spring Isolation	Yes
Rubber Isolation	Yes
Pre-Calibrated	Yes
Pre-Assembled	Yes
Made in USA	Yes

TESTED, ENGINEERED, DESIGNED, CALIBRATED, & MADE IN THE USA

RSIC®-SI-X Variants



RSIC®-SI-X ADM MULTI CLIP

- Can be shot into concrete decks for fast installation
- Low-profile and lower-cost spring isolator
- Eliminates extra cost and labor of cold-rolled channel
- Adjustable plenum depths from ~3" to 6" (custom lengths available)

The innovative Multi Clip with the RSIC-SI-X creates a fast and easy-to-install isolator that is an ideal alternative to standard 1" deflection ceiling spring isolators. Its low profile makes it ideal for situations where high levels of sound isolation are required, and ceiling height is at a premium. It is commonly used for apartment and hotel amenity spaces and in high-end condominiums.

RSIC®-SI-X 1.5 CRC

- Attaches directly to cold-rolled channel (aka black iron)
- Reduces potential conflicts with MEP
- Eliminates conflicts with sway bracing, uplift struts, etc.
- Recommended plenum depth 12"+



The RSIC-SI-X CRC is designed for use with any joist or concrete application where a dropped drywall ceiling is required. The CRC top clip snaps onto cold rolled channel, allowing for all of the wires/pencil rods, sway bracing, and uplift struts supporting the cold rolled channel to be hard connected to the ceiling above.

RSIC®-SI-X Variants



RSIC®-SI-X LP

- Mounts to the side of solid wood joists, wood I-joists, or wood open-web trusses
- Allows the hat channel to be run parallel to the joists/trusses to minimize the ceiling drop

The RSIC-SI-X LP comes with a triangular mounting bracket that allows it to be mounted directly to the side of a joist. This allows the hat channel to be run between the joists to maximize the ceiling height with a cavity between the joists and gypsum board as small as ½". This provides high levels of sound isolation with a minimal drop in ceiling height.

RSIC®-SI-X EXT04

- Mounts to the side of solid wood joists, wood I-joists, or wood open-web trusses
- Allows the ceiling height to be adjusted by changing the placement of the bracket to accommodate for joists/trusses that aren't level or to create space for small MEP equipment like conduit and pipes



The RSIC-SI-X EXT04 is designed for use where an additional drop for HVAC, plumbing, or electrical chases is needed. This clip gives you the flexibility to drop a ceiling as much as 4" from its original height. The RSIC-SI-X EXT04 is also used to level out uneven floor joists. This clip has proven to be very popular with the home theater industry.

URBY FISHTOWN

PHILADELPHIA, PENNSYLVANIA



PRODUCT



DISTRIBUTOR

Sound Isolation Company

OVERVIEW

The PAC RSIC-SI-X sound isolation clips were installed in a mixed-use building nestled in Philadelphia, Pennsylvania. These spring isolators were strategically positioned within the ceiling to effectively curb noise transmission from the bustling restaurant and commercial areas below, ensuring a serene atmosphere in the living spaces above.

PROJECT DETAILS

172,844 sq ft of interior space, with 123,218 residential sq ft, 5,264 sq ft of space reserved for amenities, and a ground-floor commercial space spanning 16,429 sq ft. The residences will include 28 studios, 141 one-bedroom, and 35 two-bedroom units, and 70 bicycle spaces

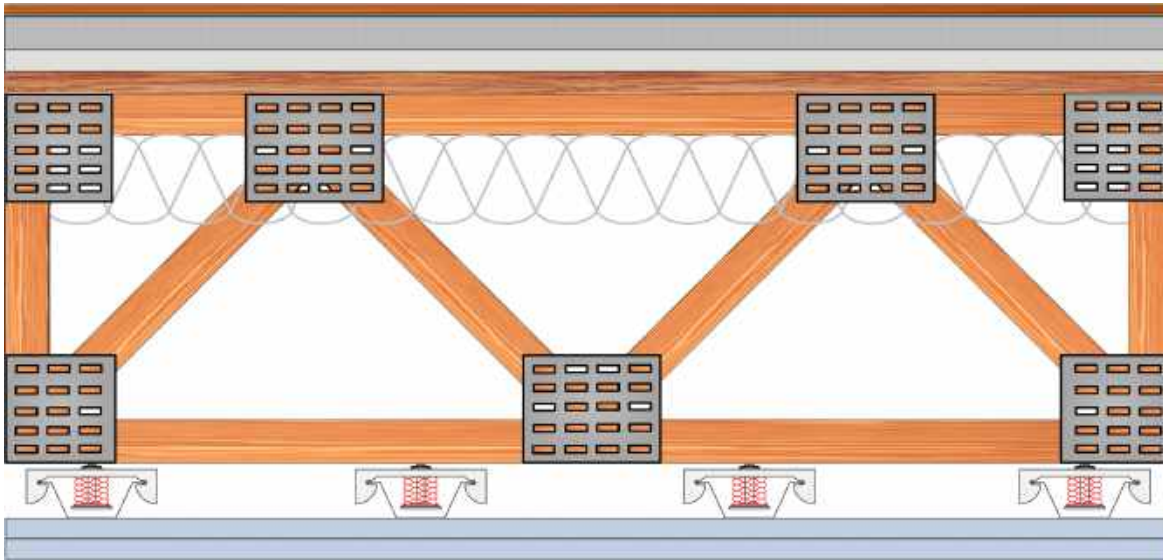

**A lower-cost alternative to standard
spring hangers**



Superior low-frequency performance



Included in over 14 UL fire-resistive designs



Easy to install



PAC-IFB

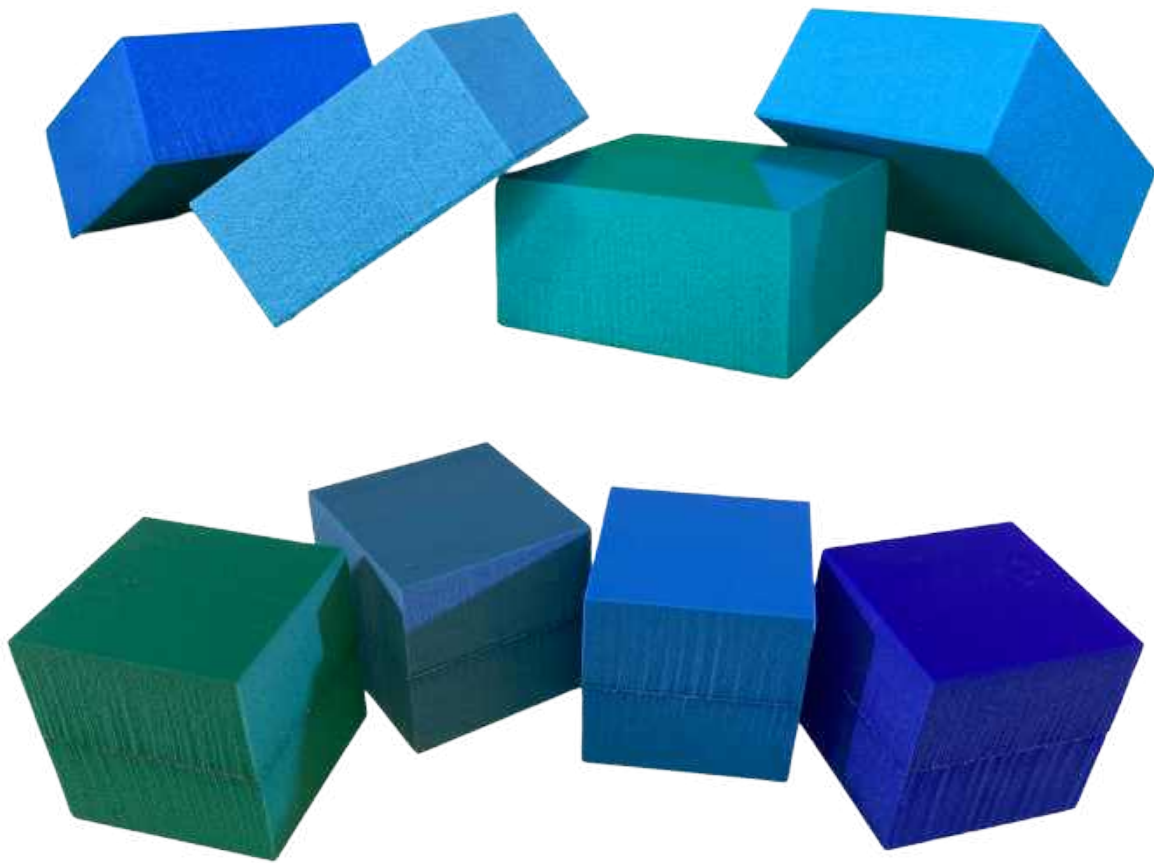

**LOW-PROFILE & HIGH-PERFORMANCE
FLOATING FLOORS**

PAC ISOLATING FLOOR BLOCKS

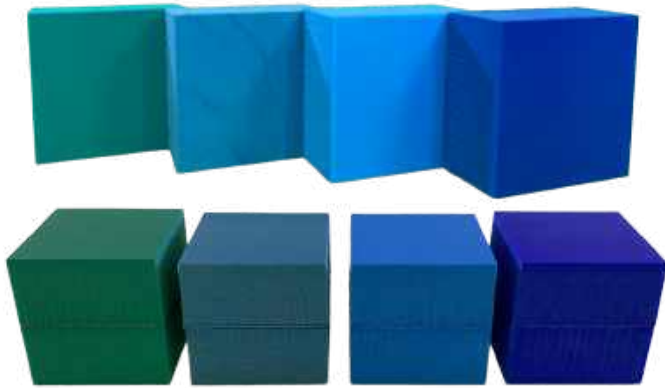

Floating floors are a go-to solution when high levels of airborne and impact sound isolation are needed. The PAC-IFB1 and PAC-IFB2 are discrete isolators for floating floors that are designed to provide high performance in a low-profile form factor. Available in a variety of load ranges with detailed product performance data for all, the PAC-IFB has the data engineers need to create solutions that work. The PAC-IFB is made from the same elastomeric material that's been used for years in Europe for whole-building vibration isolation, so you know it's a reliable long-term solution.

APPLICATIONS

- Cinemas & Clubs
- Bowling Alleys
- Fitness Facilities
- Ballrooms
- Theaters/Auditoriums
- Gymnasiums
- Dance Studios
- Spin/Cycle Rooms

STANDARD GRADES

- 170
- 260
- 400
- 650

OTHER GRADES AVAILABLE

- 10
- 16
- 26
- 40
- 65
- 110
- 950
- 1300
- 1900

TYPICAL ASSEMBLIES

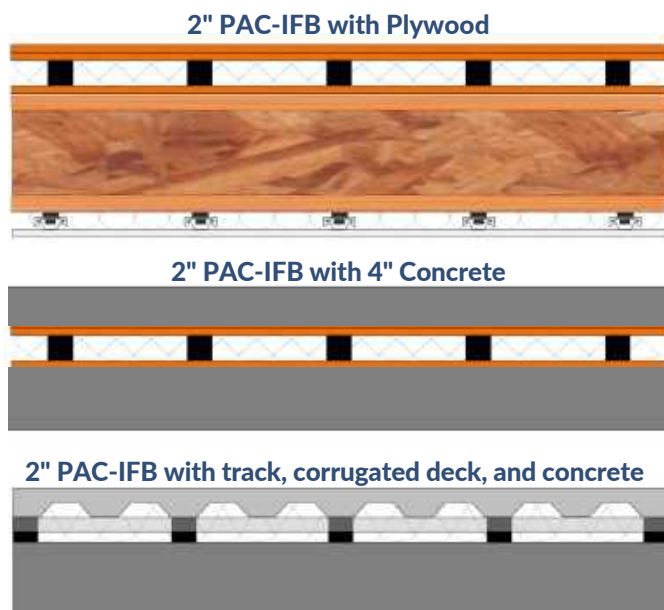

SPECIFICATIONS

Standard Thicknesses	1" & 2"
Available Material Grades	13
Custom Shapes & Sizes	Yes
Manufacturer Supplied Layout	Included
Cavity Minimum	1"
Use in New Construction	Yes
Use in Retrofit	Yes
Use in Floors	Yes

Layout

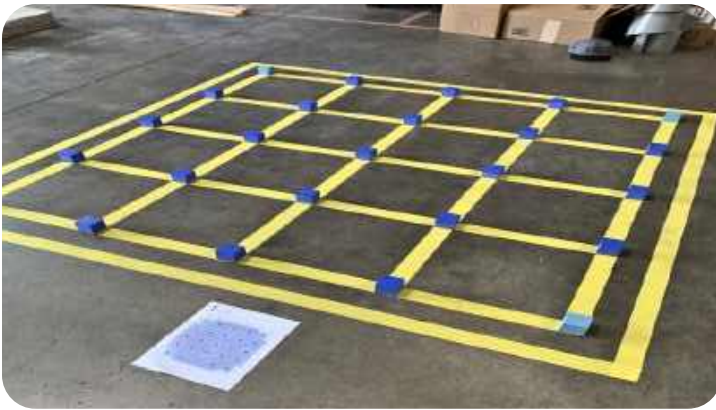

Insulation



Plywood



- Isolator sizes
 - Typically 2"x2" squares that are 1" or 2" thick
 - Custom sizes and thicknesses available
- Isolator spacing
 - Typically 16" x 16"
 - Spacing can be decreased to accommodate heavier loads
 - Isolators can be held in place with spray adhesive
- Insulation
 - Supplied by others for flexibility and ease of shipping
 - Fiberglass, mineral wool, and other fibrous insulations can be used
 - 2" thick insulation can be used with 1" or 2" PAC-IFBs

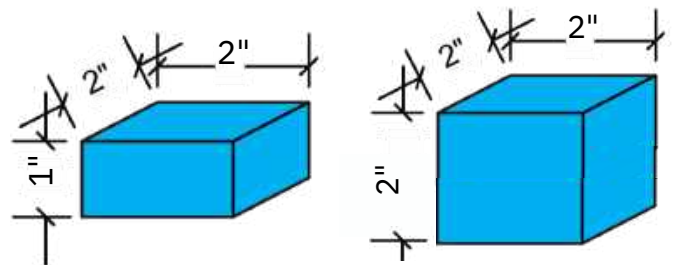

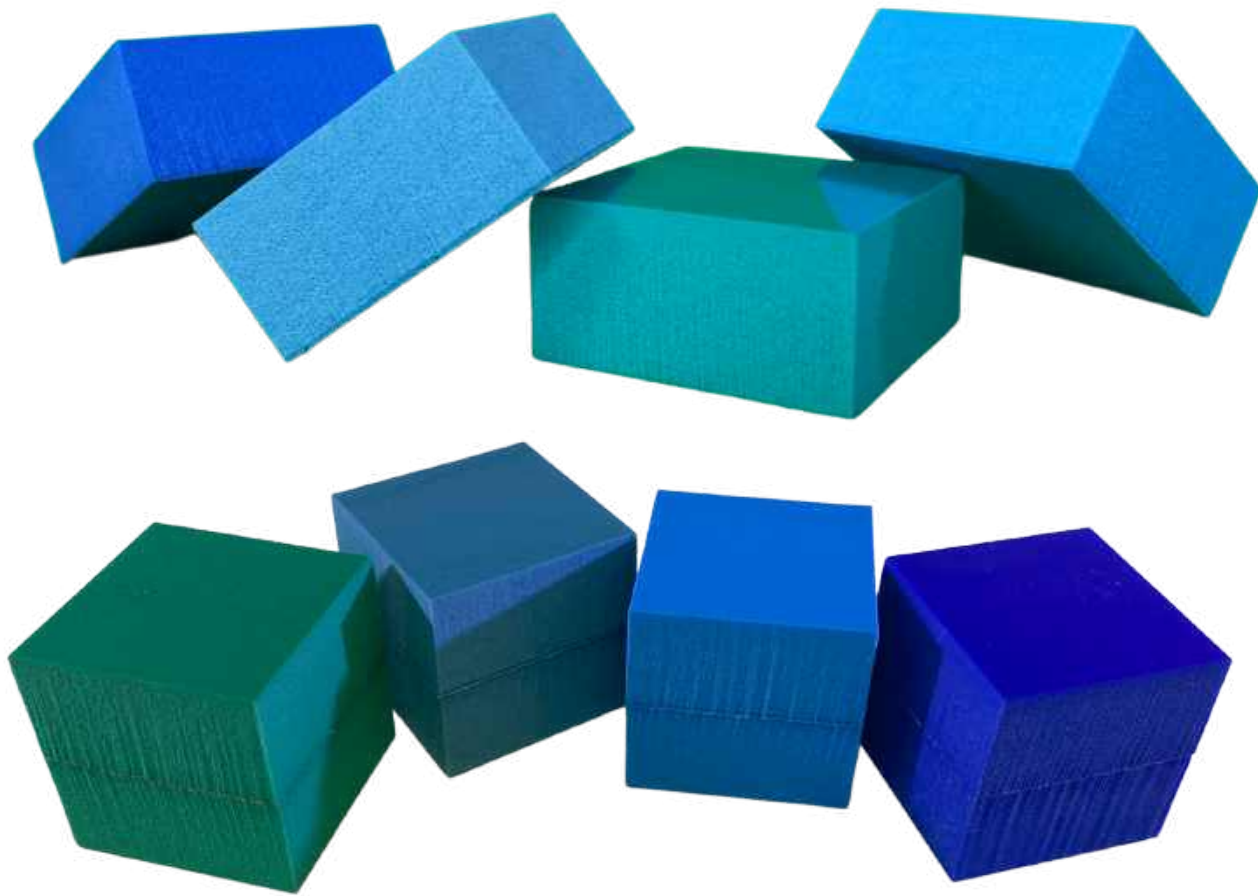

Detailed load vs. natural frequency data



Low-profile systems with high performance



Natural frequency down to 7.5 Hz



Low creep



SPRING ISOLATORS

RSIC®-SI-1 Ultra

RSIC®-SI-WHI

RSIC®-SI-CRC EZ



**HIGH-PERFORMANCE SIDE-MOUNT
SPRING & RUBBER HANGERS**

TESTED, ENGINEERED, & DESIGNED IN THE USA

The RSIC-SI-1 Ultra is a high-quality and top-performing ceiling hanger for wood or steel joists that dramatically reduces low-frequency airborne and impact noise. This is done by decoupling and isolating the gypsum board from the structure, increasing the acoustical performance of the system by reducing the transfer of noise and vibration that would typically be allowed to transfer through the structure. The RSIC-SI-1 Ultra includes a RSIC-1 clip which allows hat channel to be snapped directly into the spring hanger. This innovation significantly reduces installation times compared to competing products.



Yellow
5 Lbs



White
10 Lbs



Blue
20 Lbs



Green
30 Lbs



Red
40 Lbs

APPLICATIONS

Condominiums

Apartment Buildings

Hospitality Spaces

Mixed-Use Buildings

TYPES OF SYSTEMS



Wood Open Web Truss



Wood "I" Joist

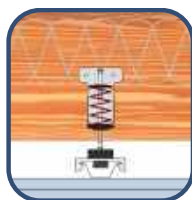

Wood Solid Joist



Steel Open Web Truss

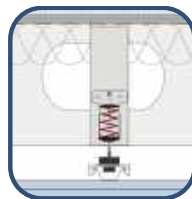

Steel Joist

SPECIFICATIONS

Acoustical Design Load	5 Lbs - 40 Lbs
Total Deflection	1"
Pre-Loaded	Yes
Pre-Assembled	Yes
Adjustable	Yes
Use in Ceilings	Yes
Use in Walls	No
Use in New Construction	Yes
Use in Retrofit	Yes
Spring Isolation	Yes
Rubber Isolation	Yes

TESTED, ENGINEERED, & DESIGNED IN THE USA

The RSIC-SI-CRC EZ is a high-quality and top-performing ceiling hanger for wood or steel joists that dramatically reduces low-frequency airborne and impact noise. This is done by decoupling and isolating the gypsum board from the structure, increasing the acoustical performance of the system by reducing the transfer of noise and vibration that would typically be allowed to transfer through the structure. The RSIC-SI-CRC EZ includes an innovative, labor saving EZ clip created by PAC International to ease installation by allowing the channel to be snapped into place. This innovation significantly reduces installation times compared to competing products.



APPLICATIONS

Condominiums

Apartment Buildings

Hospitality Spaces

Mixed-Use Buildings

TYPES OF SYSTEMS



Wood Open Web Truss



Wood "I" Joist



Wood Solid Joist

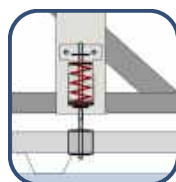

Steel Open Web Truss



Steel Joist

SPECIFICATIONS

Acoustical Design Load	5 Lbs - 80 Lbs
Total Deflection	1"
Pre-Loaded	Yes
Pre-Assembled	Yes
Adjustable	Yes
Use in Ceilings	Yes
Use in Walls	No
Use in New Construction	Yes
Use in Retrofit	Yes
Spring Isolation	Yes
Rubber Isolation	Yes

TESTED, ENGINEERED, & DESIGNED IN THE USA

The RSIC-SI-WHI is a high-quality and top-performing ceiling hanger for wood or steel joists that dramatically reduces low-frequency airborne and impact noise. This is done by decoupling and isolating the gypsum board from the structure, increasing the acoustical performance of the system by reducing the transfer of noise and vibration that would typically be allowed to transfer through the structure. The RSIC-SI-WHI comes direct from the factory with a pre-installed wire eye-nut for easy installation of standard drywall grid ceilings.



Yellow
5 Lbs



White
10 Lbs



Blue
20 Lbs



Green
30 Lbs



Red
40 Lbs



Silver
80 Lbs

APPLICATIONS

Condominiums

Apartment Buildings

Hospitality Spaces

Mixed-Use Buildings

TYPES OF SYSTEMS



Wood Open
Web Truss



Wood "I" Joist

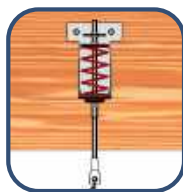

Wood Solid
Joist



Steel Open
Web Truss



Steel Joist

SPECIFICATIONS

Acoustical Design Load	5 Lbs - 80 Lbs
Total Deflection	1"
Pre-Loaded	Yes
Pre-Assembled	Yes
Adjustable	Yes
Use in Ceilings	Yes
Use in Walls	No
Use in New Construction	Yes
Use in Retrofit	Yes
Spring Isolation	Yes
Rubber Isolation	Yes

PRODUCT



**LUXURY
CONDOMINIUMS**

OVERVIEW

In this project design, resilient channels were used for the ceiling isolation. When the condominium owners moved in they were very unsatisfied with the provided level of noise control. An acoustical consultant was brought in to provide solutions and they ultimately recommended the PAC RSIC-SI-1 Ultra which provided such great isolation that the acoustic engineers could not hear flooring being removed in a unit above during a site visit.

PROJECT DETAILS

1,086-3,014 sq ft, 3-bedroom residences, pool, spa/hot tub, exercise room, midrise building, parking garage, private patios, balconies, and concierge

DISTRIBUTOR

Valley Design Group



**THE RESERVE AT MENDOTA
VILLAGE**
MENDOTA HEIGHTS, MINNESOTA

PROJECT DETAILS

5 stories, 243,684 sq ft, 138 residential units, outdoor pool, sundeck, rooftop patio, pickleball courts, recreational lounge with HD multisport simulator, fitness center with functional fitness system, yoga studio, wine bar, rooftop solar garden, and climate-controlled garage

OVERVIEW

The PAC RSIC-SI-CRC EZ spring isolators were installed in the ceiling of the top floor units to isolate them from the fitness amenity spaces above. The amenity spaces included a gym, a golf lounge and simulator, and pickleball courts. PAC worked closely with the acoustical consultant to project-specific construction details.

PRODUCT



DISTRIBUTOR

MC Drywall



Pre-Assembled & Pre-Loaded



Rubber and spring isolation



Included in over 92 UL fire-resistive designs



Labor saving attachment for drywall furring channel



Pre-Assembled & Pre-Loaded



Rubber and spring isolation



Included in over 92 UL fire-resistive designs



Labor-saving attachment for cold-rolled channel



Pre-Assembled & Pre-Loaded



Rubber and spring isolation



Labor saving attachment for drywall grid



RSIC®-SI-CRC2 LP

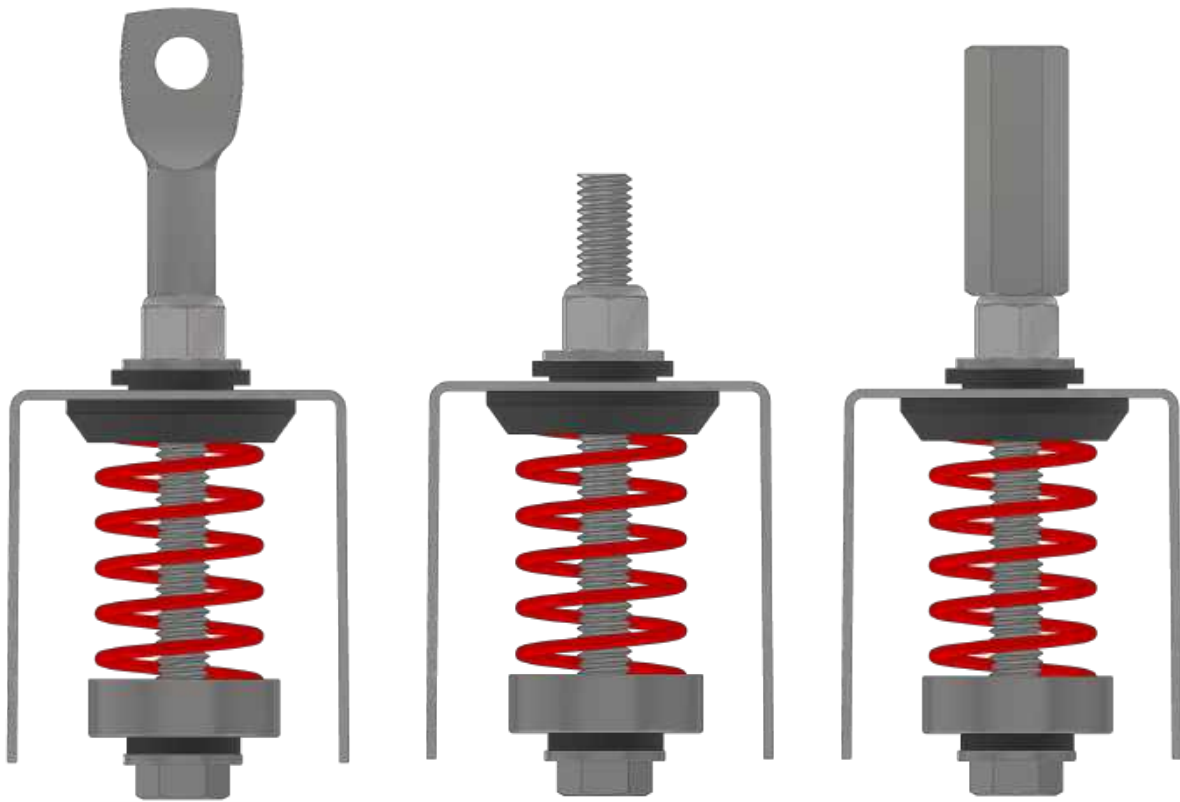

**LOW-PROFILE 1" DEFLECTION
SPRING ISOLATOR**

TESTED, ENGINEERED, & DESIGNED IN THE USA

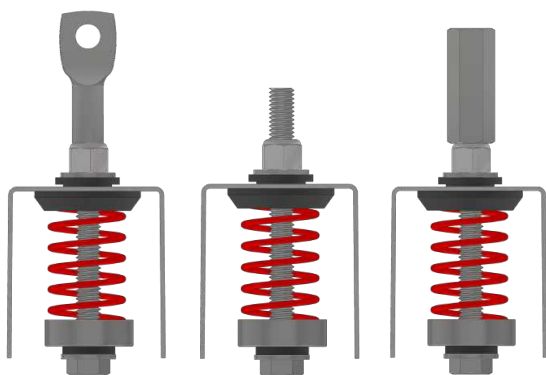

The RSIC-SI-CRC2 LP is a low-profile spring isolator that can be used in plenums as small as 3-5/8". This allows for the installation of high-performance noise barrier ceilings that maximize ceiling heights. The RSIC-SI-CRC2 LP has the added benefit of using two 1-1/2" 16ga cold-rolled channels which allows for spans of up to 6 ft. between springs. The springs come pre-loaded and fully assembled from the factory.

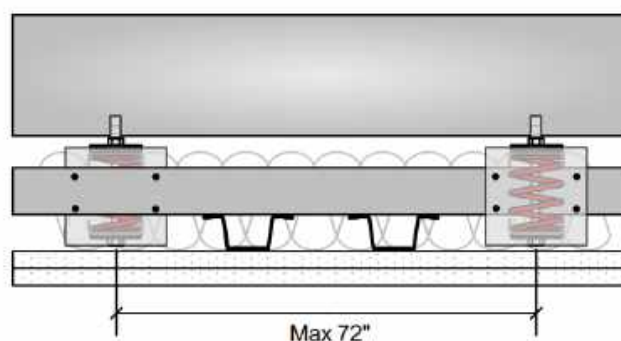
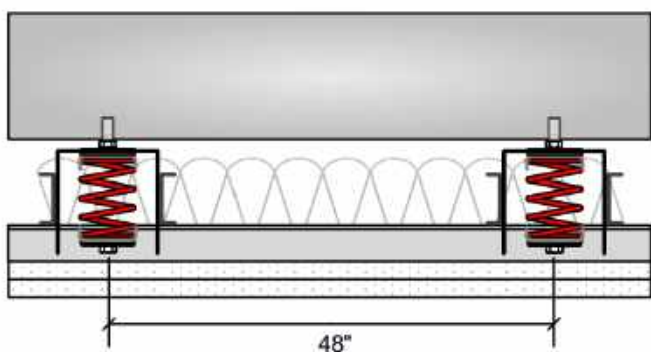

APPLICATIONS

Condominiums

Apartment Buildings

Theaters

Commercial Buildings

SPECIFICATIONS

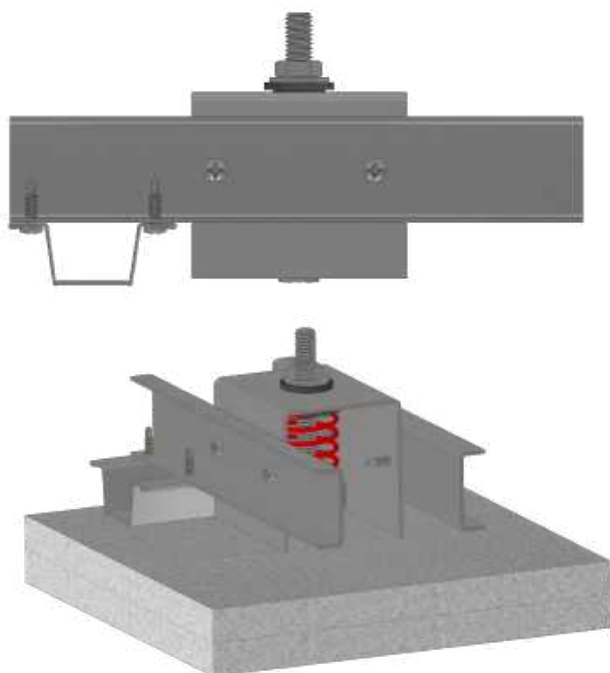

Acoustical Design Load	10 Lbs - 120 Lbs
Total Deflection	1"
Pre-Loaded	Yes
Pre-Assembled	Yes
Adjustable	Yes
Use in Ceilings	Yes
Use in Walls	No
Use in New Construction	Yes
Cavity Min	3-5/8"
Cavity Max	Unlimited

RSIC®-SI-CRC2 LP

- Low-profile 1" deflection spring isolator
- Can be mounted directly to the bottom of concrete slabs and composite decks
- Can be suspended using threaded rod, pencil rod, or wire
- Cold-rolled channel (CRC) mounted to both sides of the hanger allows for greater spans between isolators, reducing material and labor costs

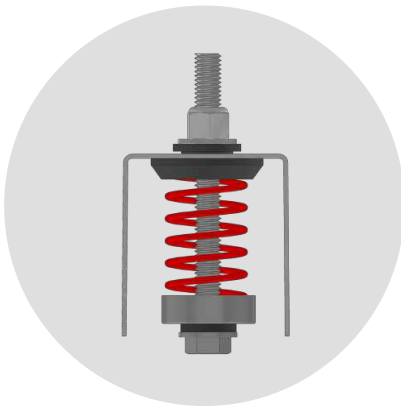

RSIC®-SI-CRC2 LP

- Can be bolted directly to the bottom of a concrete slab or composite deck
- Provides a minimum plenum depth of 3-5/8"
- Only requires one attachment point for mounting
- Can be bolted to Unistrut using standard Unistrut hardware

RSIC®-SI-CRC2 LPW

- Can be suspended using wire or pencil rod to create the required plenum depth
- Only requires one attachment point for mounting
- Provides the flexibility of using one isolator to accommodate multiple ceiling heights

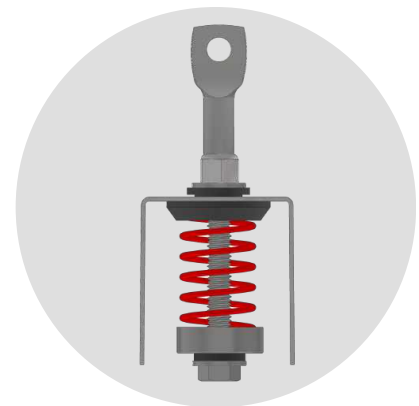

RSIC®-SI-CRC2 LPC

- Can be suspended using additional threaded rod to create the required plenum depth
- Only requires one attachment point for mounting
- Provides the flexibility of using one isolator to accommodate multiple ceiling heights

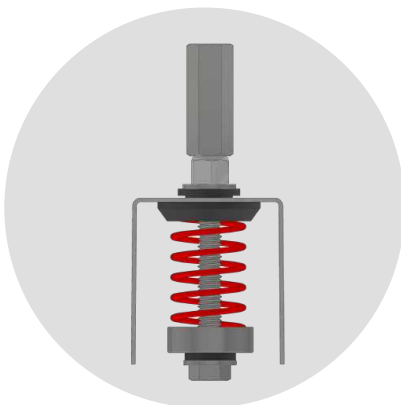

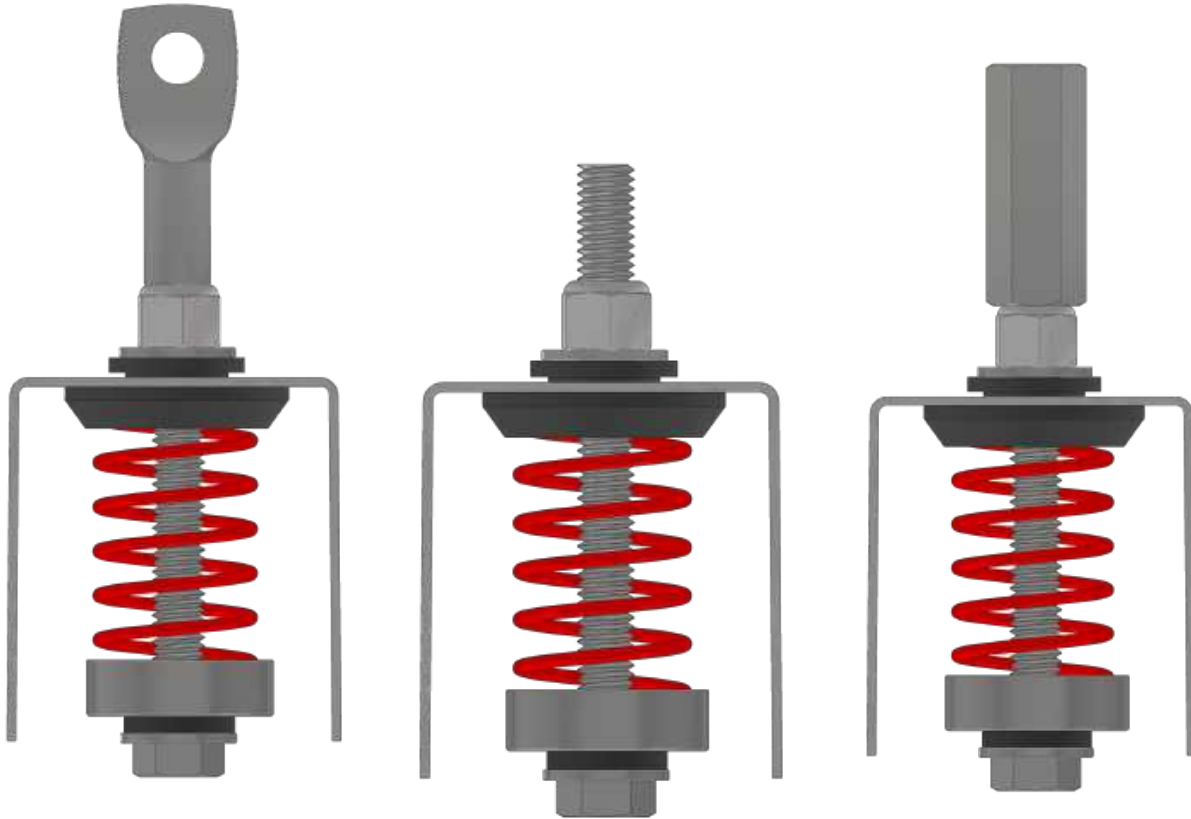

Pre-Assembled and Pre-Loaded



Attachments for multiple mounting options



High-performance spring and rubber isolation



In stock and shipping now



RSIC®-SI-FF

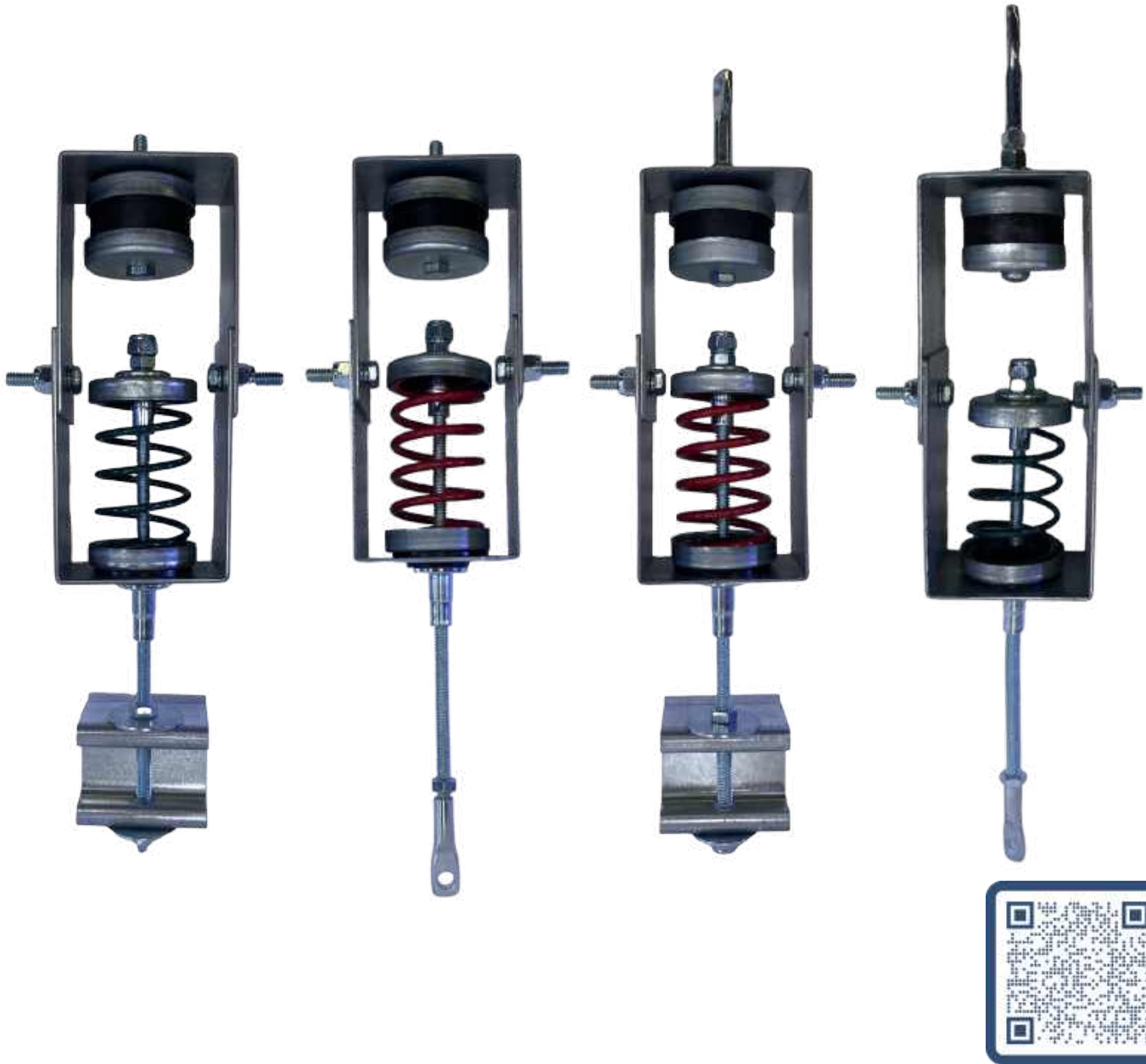

**HIGH-PERFORMANCE, TOP-MOUNT
SPRING & RUBBER ISOLATOR**

PRE-LOADED, & PRE-ASSEMBLED IN THE USA

The RSIC-SI-FF is a full-frame spring and rubber isolator that can be directly attached to concrete (BR_) or used with hanger wire (WR_) to support cold rolled channel (_RC) or drywall grid ceilings (_RW). This product features an innovative, mid-bracket hinged frame to compensate for mis-aligned installations. This is similar to the 15 degrees of vertical alignment compensation provided by competitors, but PAC's innovative hinged frame provides a much larger range of alignment compensation.

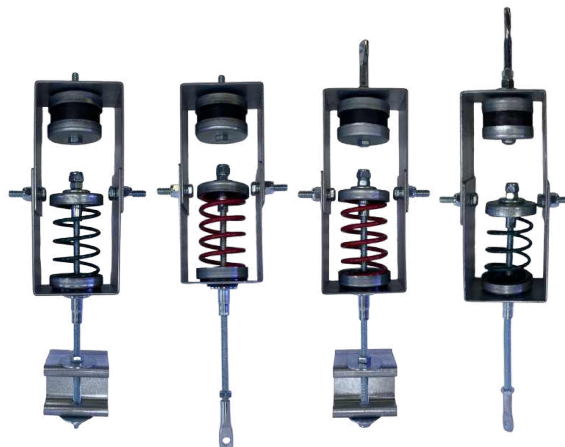

MOUNTING OPTIONS



RSIC-SI-FF-WRC EZ

Wire top mount, rubber isolator, channel bottom mount



RSIC-SI-FF-BRC EZ

Bolt top mount, rubber isolator, channel bottom mount



RSIC-SI-FF-WRW

Wire top mount, rubber isolator, wire bottom mount



RSIC-SI-FF-BRW

Bolt top mount, rubber isolator, wire bottom mount

SPECIFICATIONS

Acoustical Design Load	5 Lbs - 80 Lbs
Total Deflection	1"
Adjustable	Yes
Cavity Minimum	12"
Cavity Maximum	Unlimited
Use in Ceilings	Yes
Use in Walls	No
Use in New Construction	Yes
Use in Retrofit	Yes
Pre-Assembled	Yes
Pre-Loaded	Yes
Spring Isolation	Yes
Rubber Isolation	Yes

APPLICATIONS



MECHANICAL ROOMS



RETAIL SPACES



MULTIFAMILY BUILDINGS



THEATERS



PERFORMING ARTS VENUES



CONFERENCE ROOMS



RECORDING STUDIOS



FITNESS FACILITIES

TYPES OF SYSTEMS

Springs Under
2-Hour Wood Assembly

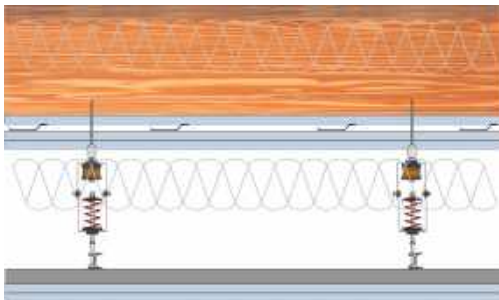

Springs Under
Concrete Assembly

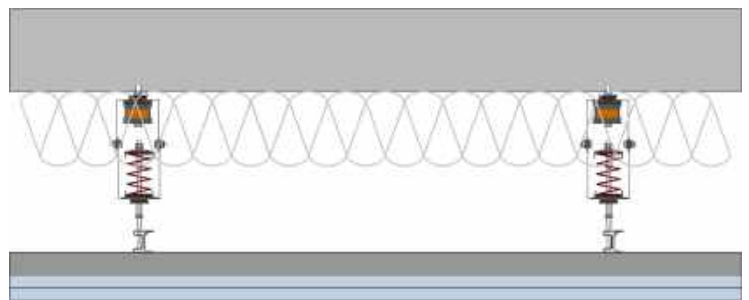

Springs Under
Mass Timber Assembly

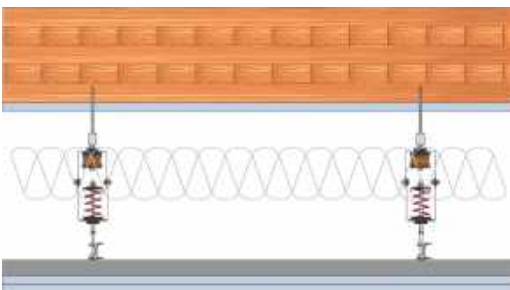

Springs Under
Corrugated Deck Assembly

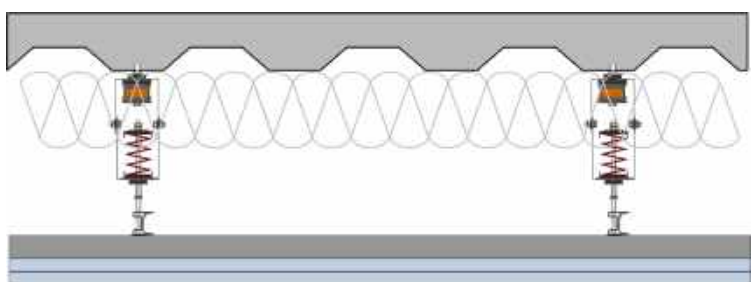

PRODUCT

RSIC®-SI-FF-WRC EZ



ORA SEAPORT
BOSTON, MASSACHUSETTS



OVERVIEW

The PAC RSIC-SI-FF-WRC EZ spring isolators were installed in the luxury apartments located in the Ora Seaport. The RSIC-SI-FF-WRC EZ was used to acoustically isolate the project's ground floor retail and restaurant space from the living units and hotel rooms above to ensure quality noise control for their residents.

PROJECT DETAILS

Dual-branded luxury apartments & Hyatt Hotel

Luxury Apartments: 300,000 sq ft, 304 residential units, rooftop pool, club room, and terrace

Hyatt Hotel: 294 rooms, 200,000 sq ft, rooftop pool and fitness center

DISTRIBUTOR

Robert N. Karpp Co., Inc.



ALEXAN JULIAN
DENVER, COLORADO

PRODUCT

RSIC®-SI-FF-BRC EZ



PROJECT DETAILS

Boutique apartment community, 311,268 sq ft, coffee bar, workspaces and meeting areas, resort-style pool and spa, courtyard, community fitness center, and yoga studio

OVERVIEW

The RSIC-SI-FF-BRC EZ was used to acoustically isolate the project's ground floor retail and restaurant space from the living units and hotel rooms above to ensure quality noise control for their residents.

DISTRIBUTOR

JDI Contractor Supply

PRODUCT



ONE RIVER NORTH
DENVER, COLORADO

OVERVIEW

The PAC RSIC-SI-FF-WRW spring isolators were installed in the luxury apartments located in Denver, Colorado. The RSIC-SI-FF-WRW was used in the penthouse suite to decouple and isolate the gypsum board ceilings from the rooftop deck, pool and outdoor space above to ensure quality noise control for the residents.

PROJECT DETAILS

Multi-family, 16 Stories, 343,000 sq ft of luxury residences, 9,000 sq ft of retail, studio to 3-bedroom residences, rooftop pool, deck, outdoor environments, fitness center, and indoor/outdoor yoga studio

DISTRIBUTOR

Western Interior Supply



LIFETIME COUNTRY CLUB AND GYM
BROOKLYN, NEW YORK

PRODUCT



PROJECT DETAILS

55,000 sq ft, studio classes, a 25-yard lap pool, basketball gym, exclusive memberships, dining, rehab and chiropractor, childcare, child swim and play, and a spa

OVERVIEW

The PAC RSIC-SI-FF-BRW spring isolators were installed in the country club and gym located in Brooklyn, New York. The RSIC-SI-FF-BRW was used in the yoga studio and cycle room to decouple and isolate the gypsum board or sheet goods from the residential units above to ensure quality noise control for the residents.

DISTRIBUTOR

Hi-Lume Corporation

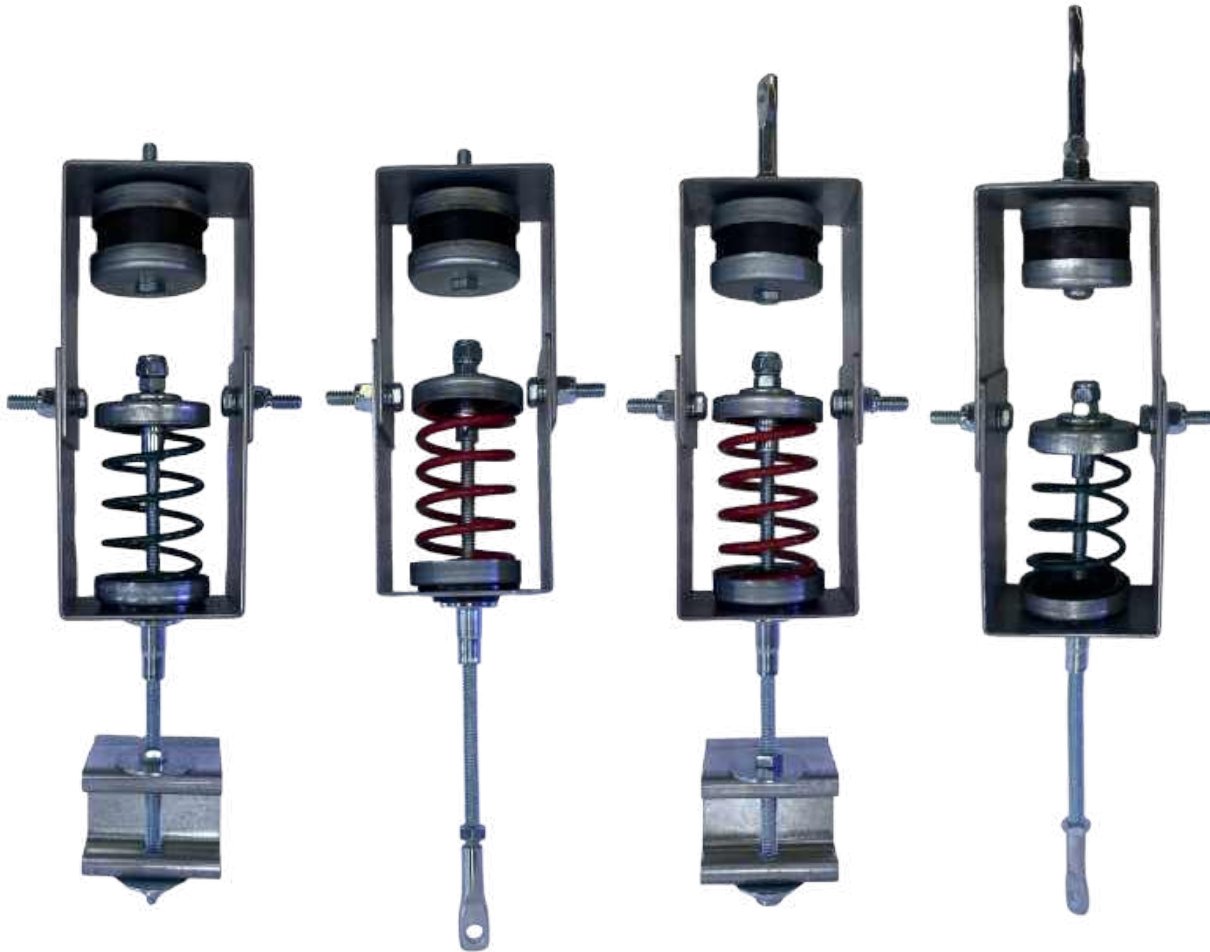

Pre-Assembled and Pre-Loaded



Attachments for multiple mounting options



High-performance spring and rubber isolation



Hinged frame to compensate for mis-aligned installations



RSIC®-SI-FF 3/8"

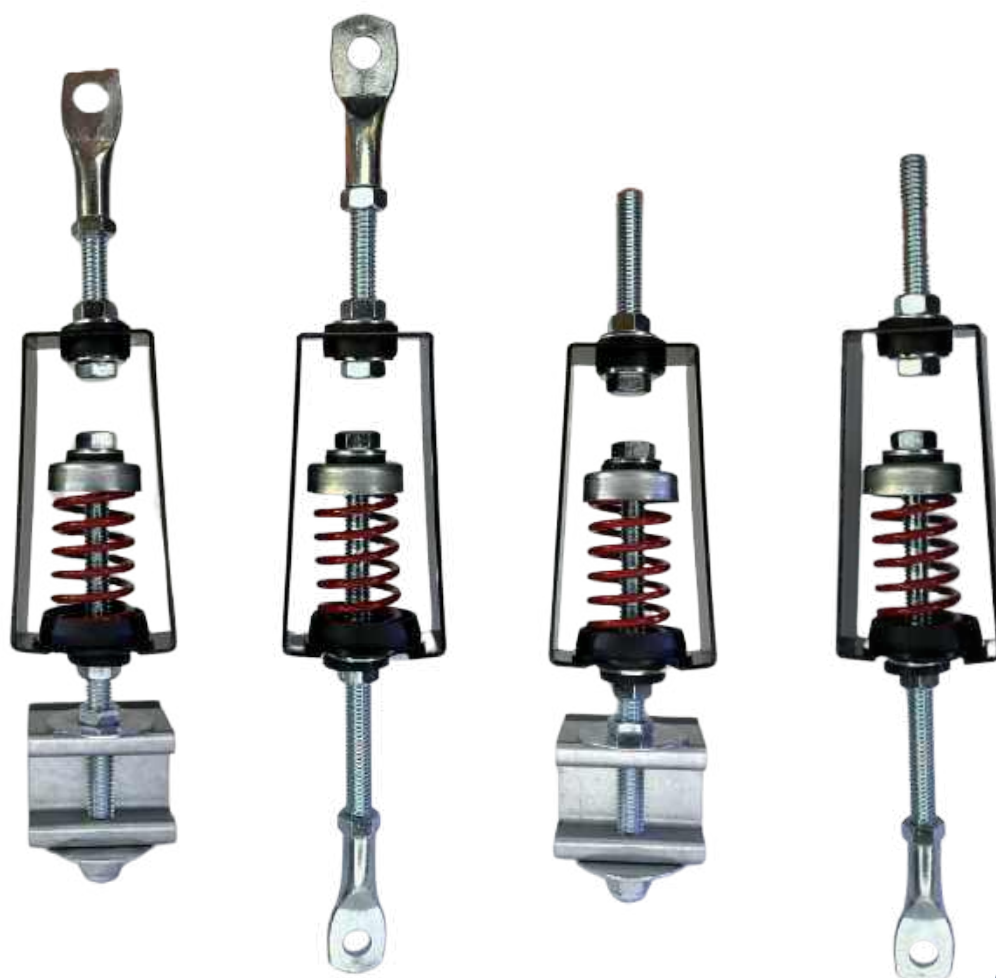

**HIGH-PERFORMANCE, TOP-MOUNT
SPRING & RUBBER ISOLATOR WITH
3/8" THREADED ROD**

TESTED, ENGINEERED, & DESIGNED IN THE USA

The RSIC-SI-FF 3/8" is a full-frame spring and rubber isolator that can be directly attached to concrete (B_) or used with hanger wire (W_) to support cold rolled channel (_C) or drywall grid ceilings (_W). This product provides 15 degrees of vertical alignment compensation as commonly specified



MOUNTING OPTIONS



RSIC-SI-FF 3/8" WC

Wire top mount, rubber isolator, channel bottom mount



RSIC-SI-FF 3/8" BC

Bolt top mount, rubber isolator, channel bottom mount



RSIC-SI-FF 3/8" WW

Wire top mount, rubber isolator, wire bottom mount



RSIC-SI-FF 3/8" BW

Bolt top mount, rubber isolator, wire bottom mount

SPECIFICATIONS

Acoustical Design Load	10 lbs - 80 Lbs
Total Deflection	1"
Adjustable	Yes
Cavity Minimum	10"
Cavity Maximum	Unlimited
Use in Ceilings	Yes
Use in Walls	No
Use in New Construction	Yes
Use in Retrofit	Yes
Pre-Assembled	Yes
Pre-Loaded	Yes
Spring Isolation	Yes
Rubber Isolation	Yes

APPLICATIONS



MECHANICAL ROOMS



RETAIL SPACES



MULTIFAMILY BUILDINGS



THEATERS



PERFORMING ARTS VENUES



CONFERENCE ROOMS



RECORDING STUDIOS



FITNESS FACILITIES

TYPES OF SYSTEMS

Springs Under 2-Hour Wood Assembly

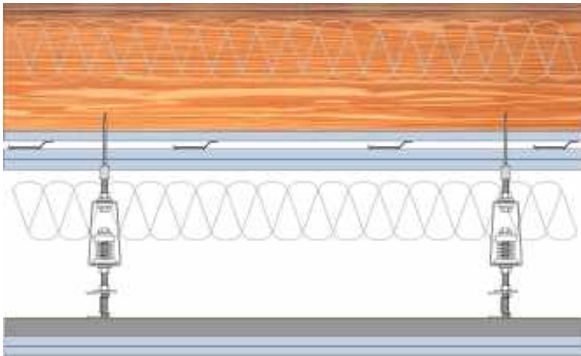

Springs Under Concrete Assembly

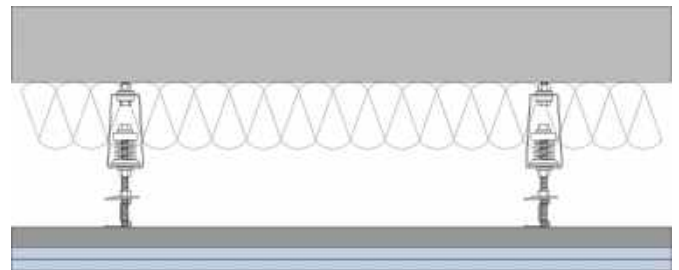

Springs Under Mass Timber Assembly

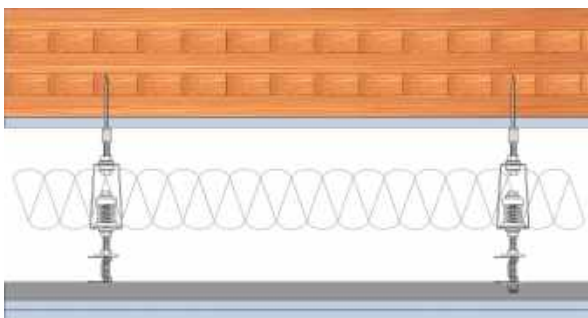

Springs Under Corrugated Deck Assembly

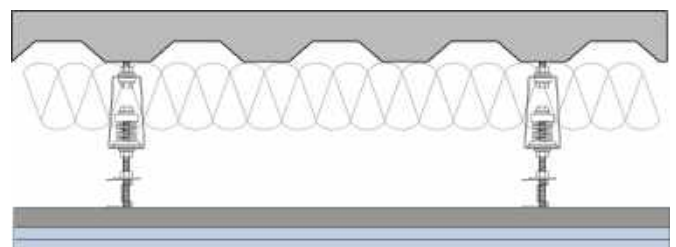

WILLOW APARTMENTS

TIGARD, OREGON



PRODUCT

RSIC®-SI-FF 3/8" BC



DISTRIBUTOR

Valhalla Construction Products

OVERVIEW

The RSIC-SI-FF 3/8" BC spring isolators were installed in the apartments located in the Tigard, Oregon. The RSIC-SI-FF 3/8" BC was used to acoustically isolate the project's ground fitness studio from the living units above to ensure quality noise control for the residents.

PROJECT DETAILS

160-unit multi-family, 1-, 2-, and 3-bedroom apartments, timber community lounge, top level sky lounge, open-air sky deck, community lounge, fitness center with open air deck

THE CONNECTIVE DENVER, COLORADO



PRODUCT

RSIC®-SI-FF 3/8" WW



OVERVIEW

The RSIC-SI-FF 3/8" WW spring isolators were installed in the apartments located in the Denver, Colorado. The RSIC-SI-FF 3/8" WW was used to acoustically isolate the project's ground fitness studio from the living units above to ensure quality noise control for the residents. Being able to safely install flat screen TVs and Murphy beds in select units.

PROJECT DETAILS

10 stories tall with 270,000 square feet of residential and retail space and below grade parking. 196 residential units with a club, pool, and fitness center.

DISTRIBUTOR

JDI Contractors



Pre-Assembled and Pre-Loaded



Attachments for multiple mounting options



High-performance spring and rubber isolation

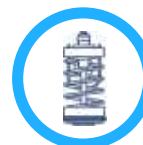

Provides 15 degrees of vertical alignment



Assembly Design Selectors

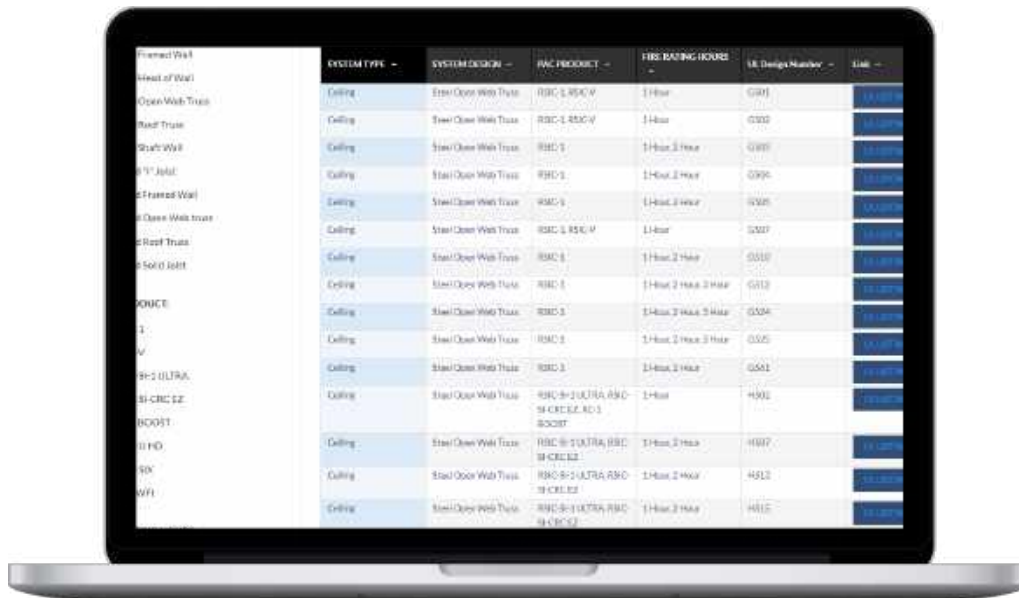
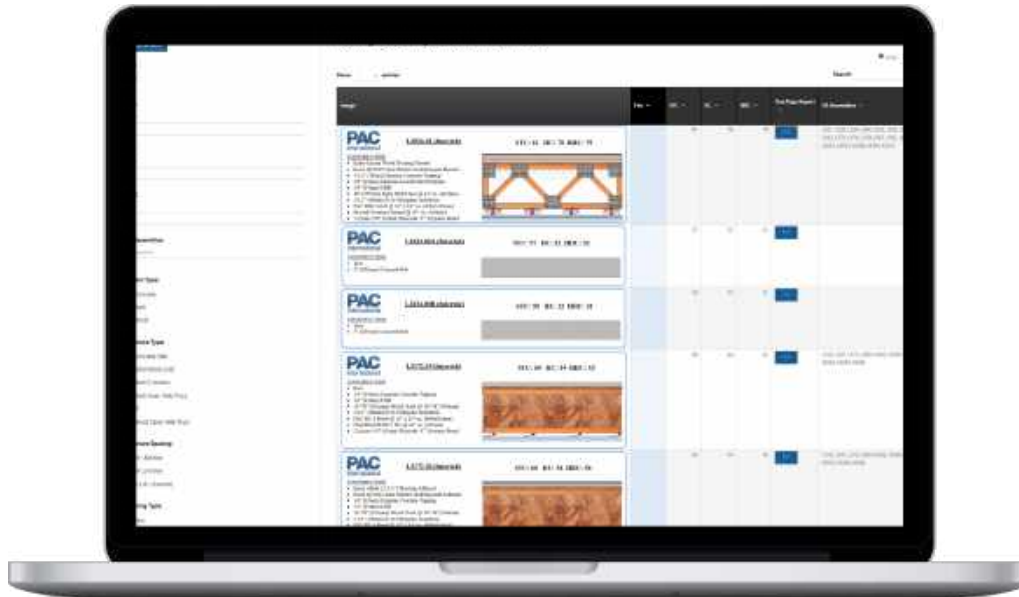

ONE-STOP SOURCE FOR
FIRE AND ACOUSTIC RATINGS

Acoustical Design Selector

Find the acoustical test data you need!

Our online wall and ceiling test database allows you to filter PAC's extensive catalog of testing to quickly find the designs and acoustical ratings that you need.



 Export data to Excel & PDF

 One-page PDF summaries for project submittals

 Active filters for quick sorting

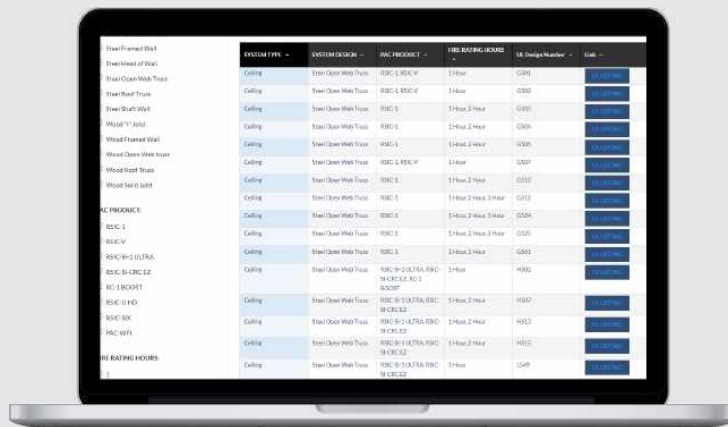

Fire-Rated Assembly Selector

Find the fire-rated assemblies you need!

Our online UL assembly databases allow you to filter PAC's extensive catalog of fire-rated designs to quickly find the assemblies that you need.



PDF of full UL designs 

Accessible to anyone 

Active filters for quick sorting 

Index

Real Solutions in Construction	1
Who is PAC	2
RSIC-1®	3
RSIC® backer	9
RC-1 Boost®	15
RSIC-1® ADM	21
PAC-RCB	25
RSIC®-SI-X	29
PAC-IFB	35
RSIC-1® Ultra/RSIC®-SI-CRC EZ/RSIC-SI-WHI	39
RSIC®-SI-CRC2 LP	45
RSIC®-SI-FF	49
RSIC®-SI-FF 3/8"	55
Assembly/Fire Selector	61
Contact Information	64

PAC International



NOISE CONTROL SOLUTIONS

REAL SOLUTIONS IN CONSTRUCTION

PAC INTERNATIONAL WEBSITE



ADDRESS

PAC International, LLC.
7260 W Azure Drive
#140-213
Las Vegas, NV 89130

PAC International, LLC.
2000 SE 4th Ave
Canby, OR 97013



PHONE

General
866.774.2100

Technical Extensions
101, 601, 801

Sales Extensions
401, 701

Accounting Extensions
202, 401



EMAIL

Request Information
info@pac-intl.com

Orders/Estimates
orders@pac-intl.com

Product/Test Data
support@pac-intl.com