



# RSIM RESILIENT SOUND ISOLATION MAT

## RSIM

The **RSIM** is designed for use with any wood, steel, or concrete floor structure where impact noise reduction is needed. The RSIM typically installs over the subfloor and directly under the finished flooring. The RSIM is available in 2mm, 3mm, 5mm, 10mm, and 12mm thicknesses. The RSIM can be installed under LVT, rigid vinyl (SPC & WPC), ceramic tile, natural stone, solid and engineered wood, laminate, carpet, lightweight concrete/ screed, and plywood rafts.



### RSIM, the Low Cost, High Performance, Noise Control Solution

Wood
Steel
Metal Deck
Concrete

Apartment
Condo
Commercial
Hotel

Recording Studio
Home Theater
Office
Single-family Homes

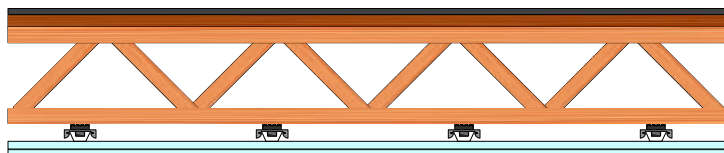
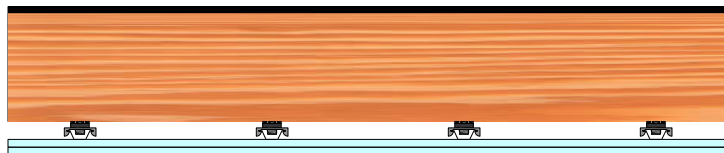

RSIM specifications:	
Thickness min.	2 mm
Thickness max.	12 mm
Use on Floors	Yes
Use on Ceilings	No
Use on walls	No
Under Tile	Yes
Under LVT, SPC, & WPC	Yes
Under Engineered Wood & Laminate	Yes

Roll Dimensions	
PAC-RSIM 2mm	4ft x75ft – 300sqft
PAC-RSIM 5mm	4ft x 30ft – 120sqft
PAC-RSIM 10mm	4ft x 15ft – 60sqft
PAC-RSIM 12mm	4ft x 15ft – 60sqft