



RSIC-SI-X ADM mini Drop in Anchor



The **RSIC-SI-X ADM mini Drop in Anchor** clip designed for use with Concrete ceilings where noise control is required. The RSIC-SI-X ADM mini Drop in Anchor isolator is a labor saving adjustable mount ceilings. Drill a hole in the Concrete, Insert the mini drop in anchor, set the anchor with setting tool and thread in the RSIC-SI-X ADM. To adjust the height, spin the isolator for a level ceiling. With an Acoustical design load rating of 7 lbs, 13 lbs and 26lbs per isolator, the RSIC-SI-X ADM mini Drop in Anchor clip can support up to two layers of 5/8" gypsum board when spaced at 16" x 48" oc. The RSIC-SI-X ADM mini Drop in Anchor clip attaches directly to the bottom of the concrete decoupling the gypsum board from the structure stopping STC and IIC vibrations from entering the space below.

RSIC-SI-X ADM mini Drop in Anchor, the High Performance, Noise control Solution

Steel
Condo
Commercial

Apartment
Retail
Conference Rooms

Recording Studio
Home Theater
Commercial theater

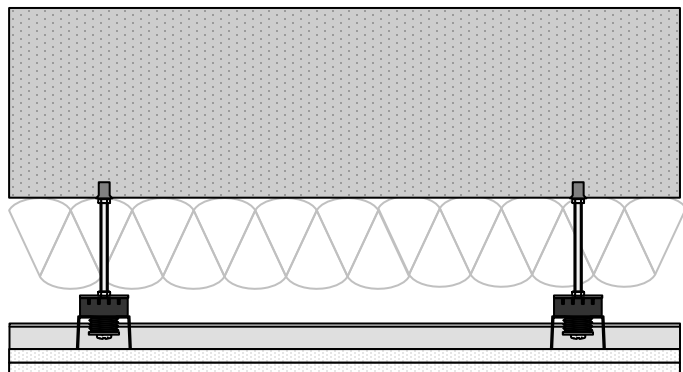
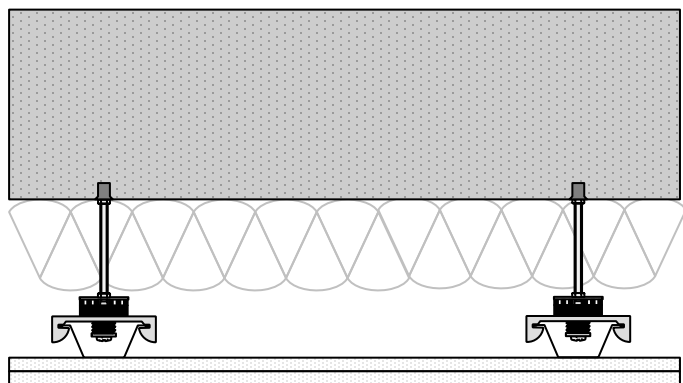

RSIC-SI-X ADM mini Drop in Anchor specifications:

Acoustical design load:	7 - 26 Lbs
Total deflection	3/8"
Double deflection	Yes (1.5 mm)
Low VOC	Yes
Adjustable	Yes
Cavity min	2"
Adjustment limit	Threaded Rod
Use on Ceilings	Yes
Use on walls	No
New Construction	Yes



World Leader
in Noise
Control
Solutions



GYPSUM BOARD ASSEMBLIES 2024

PAC INTERNATIONAL, LLC.

1. Product Name

- RSIC-SI-X ADM Mini Drop In Resilient Sound Clip
 - RSIC-SI-X ADM Mini Drop In Resilient Sound Isolation Spring Clip

2. Manufacturer

PAC International, LLC
7260 W Azure Dr
Suite 140-213
Las Vegas, NV 89130
Phone: (866) 774-2100
Fax: (866) 649-2710
Email: info@pac-intl.com
Web: www.PACInternationalLLC.com

3. Product Description

RSIC-SI-X ADM Mini Drop In

The RSIC-SI-X Multi Clip is designed for use with concrete ceiling system where noise control is needed. The RSIC-SI-X ADM Mini Drop In assembly decouples and isolates the gypsum board or other sheet goods from the structure increasing the acoustical performance of the system.

The RSIC-SI-X ADM Mini Drop In stops the noise and vibrations that typically would be allowed to transfer through the structure.

Materials and Composition

The RSIC-SI-X ADM Mini Drop In spring and rubber isolator are made of rubber and/or manufactured rubber compound, and steel parts.

Environmental Considerations

The RSIC-SI-X ADM Mini Drop In may contribute to LEEDS points, by reducing materials needed to achieve high STC and IIC floor ceiling systems.

Weight-bearing Information

With an acoustical design load rating of 26 pounds, 13 pounds and 7 pounds per isolator. The RSIC-SI-X ADM Mini Drop In can support up to two layers of 5/8 inch gypsum board when spaced at 16" x 48" oc. For heavier systems increase the number of isolators and channel to support the additional weight of the system. The RSIC-SI-X ADM Mini Drop In fastens directly to the structure.

RSIC-SI-X ADM Mini Drop In

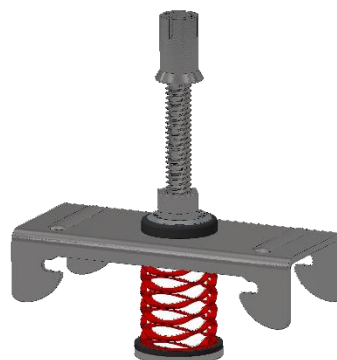

Product Limitations

For interior use only with operating temperatures of 40–100 degrees F (4.4–37.8 degrees C). Max load 26 Lbs, 13 Lbs, 7 Lbs.

4. Technical Data

Applicable Standards

ASTM International (ASTM)

- **ASTM E90** Standard Test Method for Laboratory Measurement of Airborne Sound Transmission Loss of Building Partitions and Elements
- **ASTM E492** Standard Test Method for Laboratory Measurement of Impact Sound Transmission Loss of Building Partitions and Elements
- **ASTM E413** Classification for Rating Sound Insulation

Underwriters Laboratories (UL)

- **UL Fire Resistance Directory;** www.UL.com or visit [here](#).

5. Installation

General installation: Follow manufacturer's specific installation instructions.

- Install RSIC-SI-X ADM Resilient Sound Isolation Spring Clip following the manufacturer recommendations
- Install the Dewalt mini drop in anchor per manufactures installation guide. (by others)
- Fasten the RSIC-SI-X ADM Mini Drop In to structure



**World Leader
in Noise
Control
Solutions**



GYPSUM BOARD ASSEMBLIES 2024

PAC INTERNATIONAL, LLC.

- Install 7/8" 25 Ga drywall furring channel (Hat Channel) into RSIC-SI-X ADM Mini Drop In at a maximum of 16 x 48 inches on center. 7/8" 25 GA drywall furring channel snaps into the RSIC-SI-X Low Profile bottom part creating a 1 to 2" air gap from the underside of wood and steel framing.
- Max design load of each RSIC-SI-X ADM Mini Drop In 26 Lb, 13 Lb, and 7 Lb.
- Max spacing 16" x 48" oc.
- Splicing Drywall Furring Channels:
 - Splice drywall furring channels with minimum of six inch overlap.
 - Secure laps with two framing screws or 18 gauge tie wire double wrapped
 - Locate splices between resilient sound isolation clips
 - Do not locate splices on resilient sound isolation clips
- Flanking Noise:
 - Review installation details to prevent structure-borne flanking noise
 - Do not allow drywall furring channels or gypsum board to contact wall framing members
- Gypsum Board:
 - Install gypsum board in perpendicular to the Drywall Furring Channel. Leave a 1/4 inch (6 mm) gap around perimeter for acoustical sealant application
 - Install gypsum board in accordance with ASTM C840 as specified in Section 09250
- Acoustical Sealant:
 - Seal potential air leaks with acoustical sealant to achieve best Field Sound Transmission Class (FSTC)
 - Seal electrical outlets and penetrations with acoustical sealant • Apply fire-rated acoustical sealant at locations where fire- rated assembly is required
- Putty Pad Sealant: acoustically seal with putty pads, electrical boxes in walls and ceilings in which resilient sound isolation clips are used 6. Availability and Cost Please contact PAC International, LLC. for availability and pricing information.

6. Availability and Cost

Please contact PAC International, LLC. for availability and pricing information.

7. Warranty

RSIC-SI-X ADM Mini Drop In clips are guaranteed free of manufacturer defects. Only remedy is the replacement of the defective component or components. Manufacturer is not liable for delays or extra costs.

8. Maintenance

No maintenance is necessary.

9. Technical Services

PAC International LLC. offers online product pages, installation guides, and specification sheets. Technical information can be found on the website, <http://www.PACInternationalLLC.com> or by calling 866-774-2100

Fire ratings, sound test assemblies, CAD drawings, assembly drawings and clip specifications are also on the website.

10. Filing Systems

- Additional product information is available from the manufacturer upon request

RSIC-SI-X ADM Mini Drop In INSTALLATION GUIDE



RSIC-SI-X ADM Mini Drop In

PAC International, LLC. Tel: (866) 774-2100 Web Site: www.PACInternationalLLC.com

PAC International, LLC. All Rights Reserved. • (866) 774-2100 • Fax (866) 649-2710
RSIC® is a registered Trade Mark of PAC International, LLC.

RSIC-SI-X ADM Mini Drop In INSTALLATION GUIDE

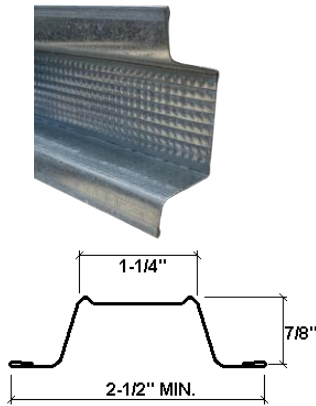

Drywall Furring Channel:

- **Channel Requirements:** 25 gauge with hemmed edge required. Meets or exceeds SSMA requirements.
- **Depth:** 7/8 inch
- **Width Bottom:** 2-9/16" to 2-11/16" inch wide nominal.
- **Width Top:** 1-1/4 inch wide

Splice drywall furring channel (hat track) with 6 inch overlap in mid span (between two clips) secure with 18 ga tie wire, or two 7/16" framing screws.



RSIC-SI-X ADM Mini Drop in:

- 3-1/4" to 4" drop = 1-1/2" bolt
- 3-1/2" to 4-1/2" drop = 2" bolt
- 4" to 5" drop = 2-1/2" bolt
- 4-1/2" to 5-1/2" drop = 3" bolt
- 5" to 6" drop = 3-1/2" bolt
- 5-1/2" to 6-1/2" drop = 4" bolt
- 6" to 7" drop = 4-1/2" bolt
- 6-1/2" to 7-1/2" drop = 5" bolt



Mini Drop In Anchor:

Dewalt mIni Drop in anchor 1/4"

06335-PWR



Resilient Sound Isolation Clip (RSIC-SI-X Spring)

- **Maximum Spacing:** 48 inches on center
- **Design Load at 3/8" deflection from free height**
- **Red = 26 Lbs**
- **Blue = 13 Lbs**
- **White = 7 Lbs**

PAC International, LLC. Tel: (866) 774-2100 Web Site: www.PACInternationalLLC.com

PAC International, LLC. All Rights Reserved. • (866) 774-2100 • Fax (866) 649-2710
RSIC® is a registered Trade Mark of PAC International, LLC.

RSIC-SI-X ADM Mini Drop In INSTALLATION GUIDE

Ceilings:

- Resilient Sound Isolation Clips (RSIC-SI-X ADM) maximum spacing 16" x 48" or 24" x 32" on center.
- Layout the RSIC-SI-X ADM clips according to general guidelines represented in this installation manual.
- Any additional or non standard room dimensions need to be addressed by a professional engineer.
- Verify the correct quantity of each RSIC-SI-X ADM isolators (weight / color) is included in the shipment.
- Layout the RSIC-SI-X ADM clips out on the floor (reflecting the ceiling above) Ensure there are no additional items required to complete the installation.
 - Red 26 Lb clips are for the field
 - Blue 13 Lb clips are for the field, edge.
 - White 7 Lb clips are for edge, corner, and or infill where additional support is needed
- Drill and install the mini drop in anchors with the included set tool and drill bits
- Install the RSIC-SI-X ADM into the mini drop in anchor
- Bend the RSIC-SI-X ADM clip down until it is parallel with the floor.
- Adjust the height of the RSIC-SI-X on the threaded rod/bolt to desired height.
- Lock RSIC-SI-X ADM into final elevation with jam/lock nut
- Ensure the metal ferrule is tight to the washer, slightly compressing the rubber
- Install the furring channel (hat track) into the RSIC-SI-X ADM clips. maximum spacing is 24" oc.
- Install the gypsum board leaving a 1/4" min. gap around the gypsum board ceiling.
- Caulk around entire perimeter of the gypsum board. Use fire rated sealant where required.



Thread length for desired drop to back of gypsum board:

- 3-1/4" to 4" drop = 1-1/2" bolt
- 3-1/2" to 4-1/2" drop = 2" bolt
- 4" to 5" drop = 2-1/2" bolt
- 4-1/2" to 5-1/2" drop = 3" bolt
- 5" to 6" drop = 3-1/2" bolt
- 5-1/2" to 6-1/2" drop = 4" bolt
- 6" to 7" drop = 4-1/2" bolt
- 6-1/2" to 7-1/2" drop = 5" bolt

General Information:

- Resilient Sound Isolation Clip (RSIC-SI-X ADM), furring channel (hat track) and gypsum board shall not carry heavy loads such as cabinets, book shelves, or light fixtures without additional RSIC supports.
- Splice furring channel (hat track) with 6 inch overlap in mid span, secure with 18 ga. tie wire or with two framing screws (7/16").
- Seal all potential air leaks with non-hardening acoustical caulking to achieve best noise control results. Use fire rated sealant where required.

PAC International, LLC. Tel: (866) 774-2100 Web Site: www.PACInternationalLLC.com

PAC International, LLC. All Rights Reserved. • (866) 774-2100 • Fax (866) 649-2710
RSIC® is a registered Trade Mark of PAC International, LLC.

RSIC-SI-X ADM Mini Drop In INSTALLATION GUIDE

RSIC-SI-X ADM SPRING INSTALLATION ON CONCRETE RSIC-SI-X ADM Mini Drop In @ 16" OC.

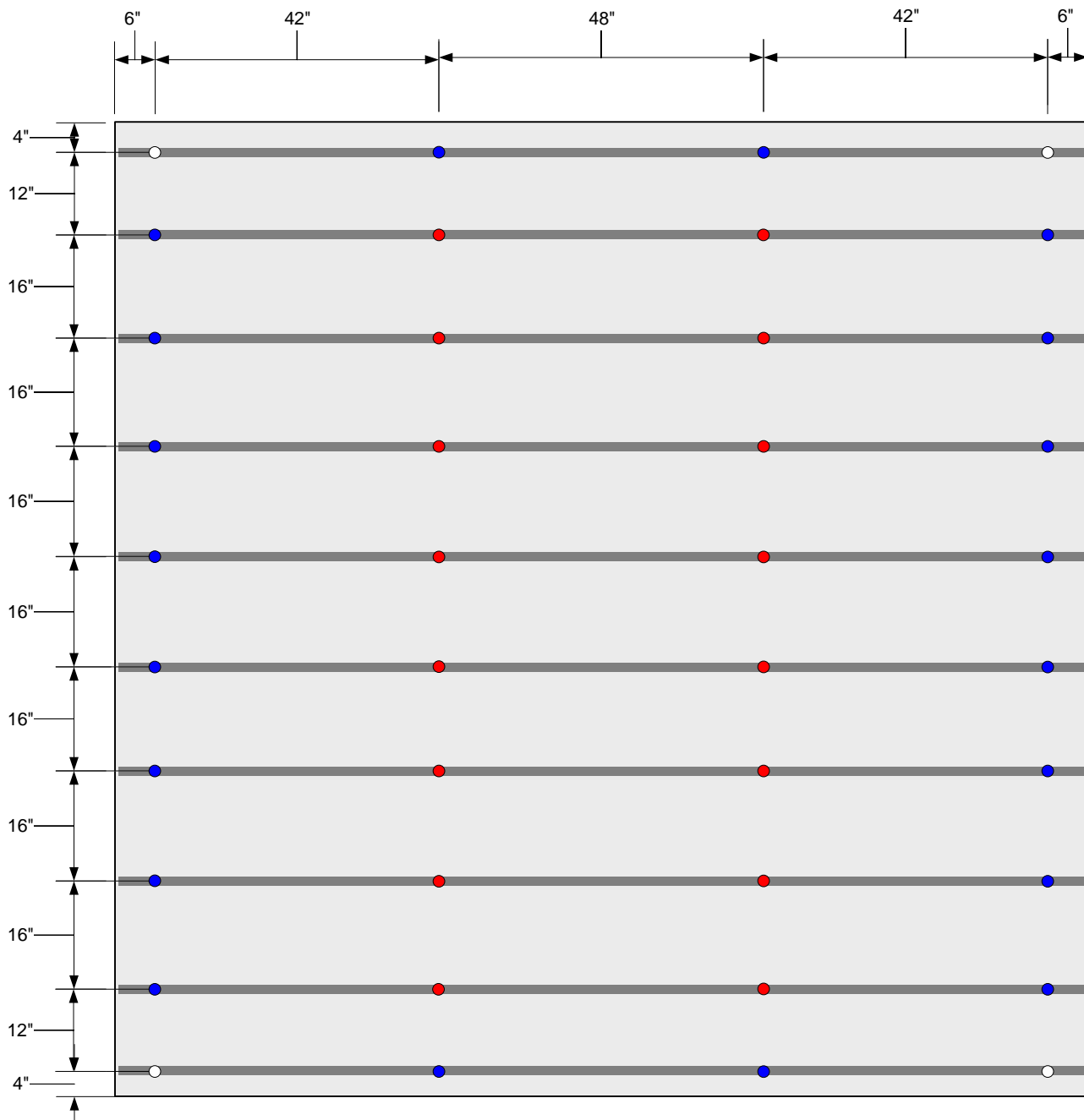

PAC International, LLC. Tel: (866) 774-2100 Web Site: www.PACInternationalLLC.com

PAC International, LLC. All Rights Reserved. • (866) 774-2100 • Fax (866) 649-2710

RSIC® is a registered Trade Mark of PAC International, LLC.



World Leader in
Noise Control
Solutions



LEED Analysis
RSIC-SI-X ADM

Recycled Content

PAC International's RSIC-SI-X ADM does not contain significant recycled content.

Fabrication Location

The RSIC-SI-X ADM is manufactured in Canby, OR 97013

Material Source

The extraction points for the materials in these products cannot be verified. Assume they are outside the 500 mile radius.



Safety Data Sheet

Article Statement

(PAC International, LLC Wall and Ceiling Isolation Products)

This document is provided for clarification of the Safety Data Sheets that you have requested for our product(s). OSHA Hazard Communication Standard requires a SDS for hazardous chemicals; however, the standard exempts all articles from the requirement. The explanation of an article is described per OSHA definition below.

Pursuant to 29 CFR 1910.1200 (b) (6) (v) and (c), the product described herein is an “article” or is otherwise excluded from OSHA regulations requiring that a Material Safety Data Sheet be prepared for it.

An article defined: manufactured item other than a fluid or particle: (i) which is formed to a specific shape or design during manufacturing; (ii) which has an end use function (s) dependent in whole or in part upon its shape or design during end use; and (iii) which does not release, or other wise result in exposure to, a hazardous chemical under normal conditions of use.

For technical information and additional resources covering these products please refer to PAC International published literature, e.g., data sheets, product drawings, and installation guidelines at www.PACInternationalLLC.com

As of the date of this document, the foregoing information is believed to be accurate and is provided in good faith to comply with applicable federal and state laws. However, no warranty or representation of law or fact, with respect to such information, is intended or given.



**World Leader in
Noise Control
Solutions**

RSIC Product Warranty Disclaimer

WARRANTY DISCLAIMER AND LIABILITY LIMITATION LANGUAGE

WARRANTY AND DISCLAIMER AND LIABILITY LIMITATION LANGUAGE ONE YEAR WARRANTY Seller warrants to the original purchaser that its products are free from defects in material or workmanship for one year from the date of purchase from seller. Any allegedly defective product that is portable must be returned to seller prepaid. If upon examination it appears to seller's satisfaction that the product is defective, seller shall repair, replace, or return the purchase price of the product at seller's option. EXCEPT FOR THE FOREGOING, THERE IS NO OTHER WARRANTY, REPRESENTATION OR CONDITION OF ANY KIND; AND ANY OTHER WARRANTY, EXPRESS OR IMPLIED, IS EXCLUDED AND DISCLAIMED. Some states do not allow limitations on implied warranties, so the above limitation may not apply to you.

LIABILITY LIMITED TO RETURN OF PURCHASE PRICE

IT IS AGREED THAT SELLER'S LIABILITY AND PURCHASER'S SOLE REMEDY, WHETHER IN CONTRACT, UNDER ANY WARRANTY, IN TORT (INCLUDING NEGLIGENCE), IN STRICT LIABILITY OR OTHERWISE, SHALL NOT EXCEED THE RETURN OF THE AMOUNT OF THE PURCHASE PRICE PAID BY PURCHASER, AND UNDER NO CIRCUMSTANCES SHALL SELLER BE LIABLE FOR ANY SPECIAL, INCIDENTAL OR CONSEQUENTIAL DAMAGES, INCLUDING, BUT NOT LIMITED TO, PERSONAL INJURY, PROPERTY DAMAGE, DAMAGE TO OR LOSS OF EQUIPMENT, LOST PROFITS OR REVENUE, COSTS OF RENTING REPLACEMENTS AND OTHER ADDITIONAL EXPENSES, EVEN IF SELLER HAS BEEN ADVISED OF THE POSSIBILITY OF SUCH DAMAGES. THE PRICE STATED FOR THE EQUIPMENT IS A CONSIDERATION IN LIMITING SELLER'S LIABILITY AND PURCHASER'S REMEDY. Some states do not allow the exclusion or limitation of incidental or consequential damages, so the above limitation or exclusion may not apply to you.

SELLER NOT LIABLE FOR PURCHASER'S NEGLIGENCE

SELLER WILL NOT BE LIABLE FOR ANY DAMAGES, LOSSES OR EXPENSES AS A RESULT OF PURCHASER'S NEGLIGENCE, WHETHER DEEMED ACTIVE OR PASSIVE AND WHETHER OR NOT ANY SUCH NEGLIGENCE IS THE SOLE CAUSE OF ANY SUCH DAMAGE, LOSS OR EXPENSE.

MODEL FOR DEMONSTRATION PURPOSES ONLY

THE MODEL OR SAMPLE SHOWN BY SELLER TO BUYER IS USED FOR DEMONSTRATION PURPOSES ONLY. THERE IS NO WARRANTY THAT THE GOODS AS DELIVERED SHALL CONFORM TO THE MODEL OR SAMPLE, AND CONFORMITY OF THE GOODS TO THE MODEL OR SAMPLE IS NOT PART OF THE BASIS OF THE BARGAIN BETWEEN SELLER AND BUYER.

NO WARRANTY OR COMPLIANCE WITH SAFETY CODE OR REGULATION

SELLER DOES NOT WARRANT THAT ANY OF THE GOODS SOLD WILL MEET OR COMPLY WITH THE REQUIREMENTS OF ANY SAFETY CODE, BUILDING OR DWELLING CODE, OR REGULATION OF ANY STATE, MUNICIPALITY OR OTHER JURISDICTION.

NEVADA LAW APPLIES

SELLER AND BUYER AGREE THAT ALL ASPECTS OF THIS TRANSACTION INCLUDING THE APPLICABLE STATUTE OF LIMITATIONS SHALL BE GOVERNED BY THE INTERNAL LAW OF THE STATE OF NEVADA, AND NOT THE LAWS OF CONFLICTS.

This warranty gives you specific legal rights, and you may also have other rights which vary from state to state