

PAC International, Inc. RSIC-1 FS System Up to 37" (120 lb max)

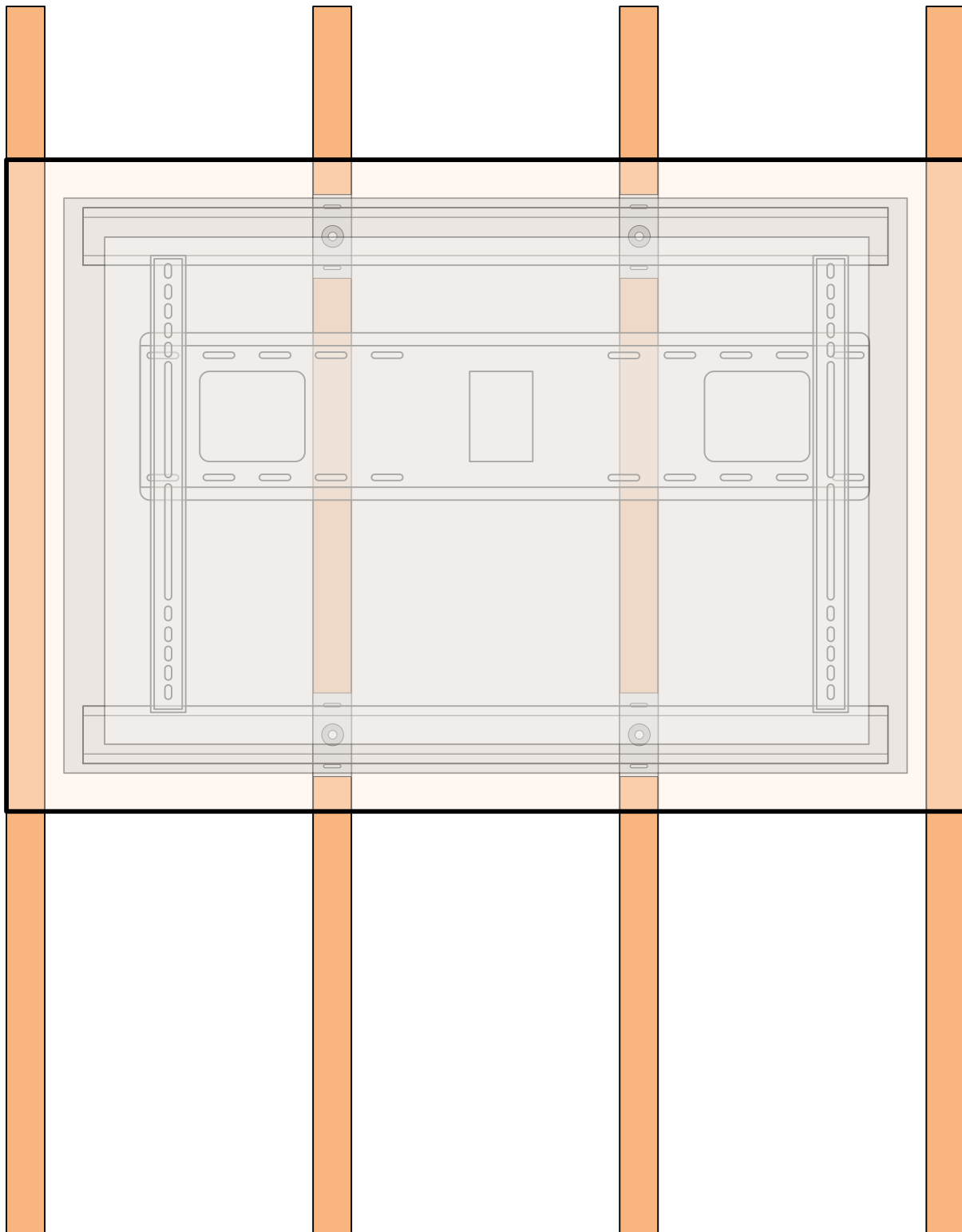

PAC International, Inc. RSIC-1 FS System Up to 37" (120 lb max)

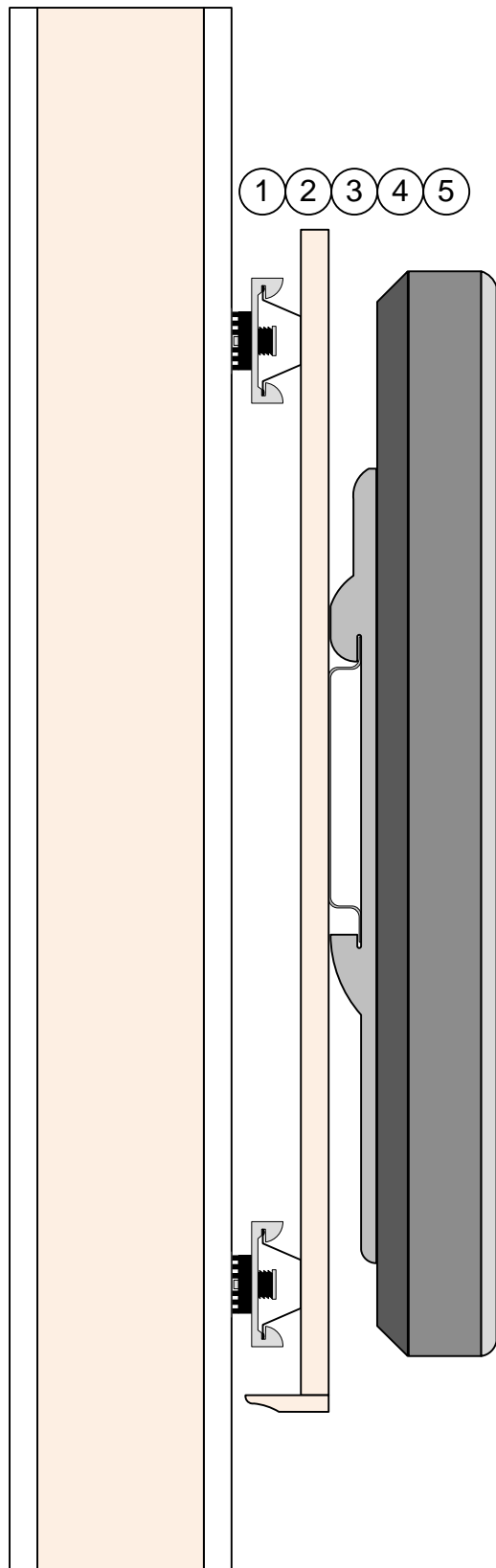

SIDE VIEW

1. RSIC-1 with retro Washer
2. 7/8" Drywall Furring Channel (By others)
3. 3/4" Finish Grade Plywood (Painted, stained, or covered with fabric/carpet) (By others)
4. Flat Screen wall mount (By others)
5. Flat Screen Television (By others)

PAC International, Inc. RSIC-1 FS System Up to 37" (120 lb max)

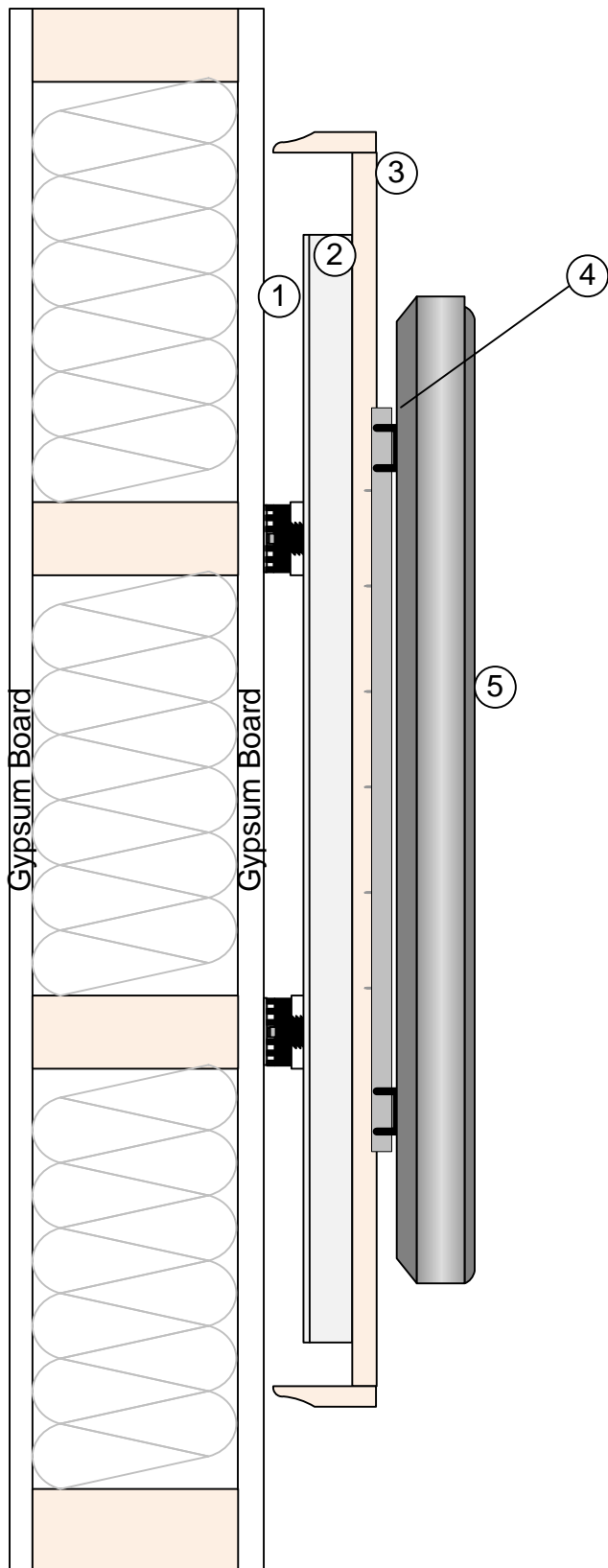

TOP VIEW

1. RSIC-1 with retro Washer
2. 7/8" Drywall Furring Channel (By others)
3. 3/4" Finish Grade Plywood (Painted, stained, or covered with fabric/carpet) (By others)
4. Flat Screen wall mount (By others)
5. Flat Screen Television (By others)

PAC International, Inc. RSIC-1 FS System Up to 37" (120 lb max)

Layout options

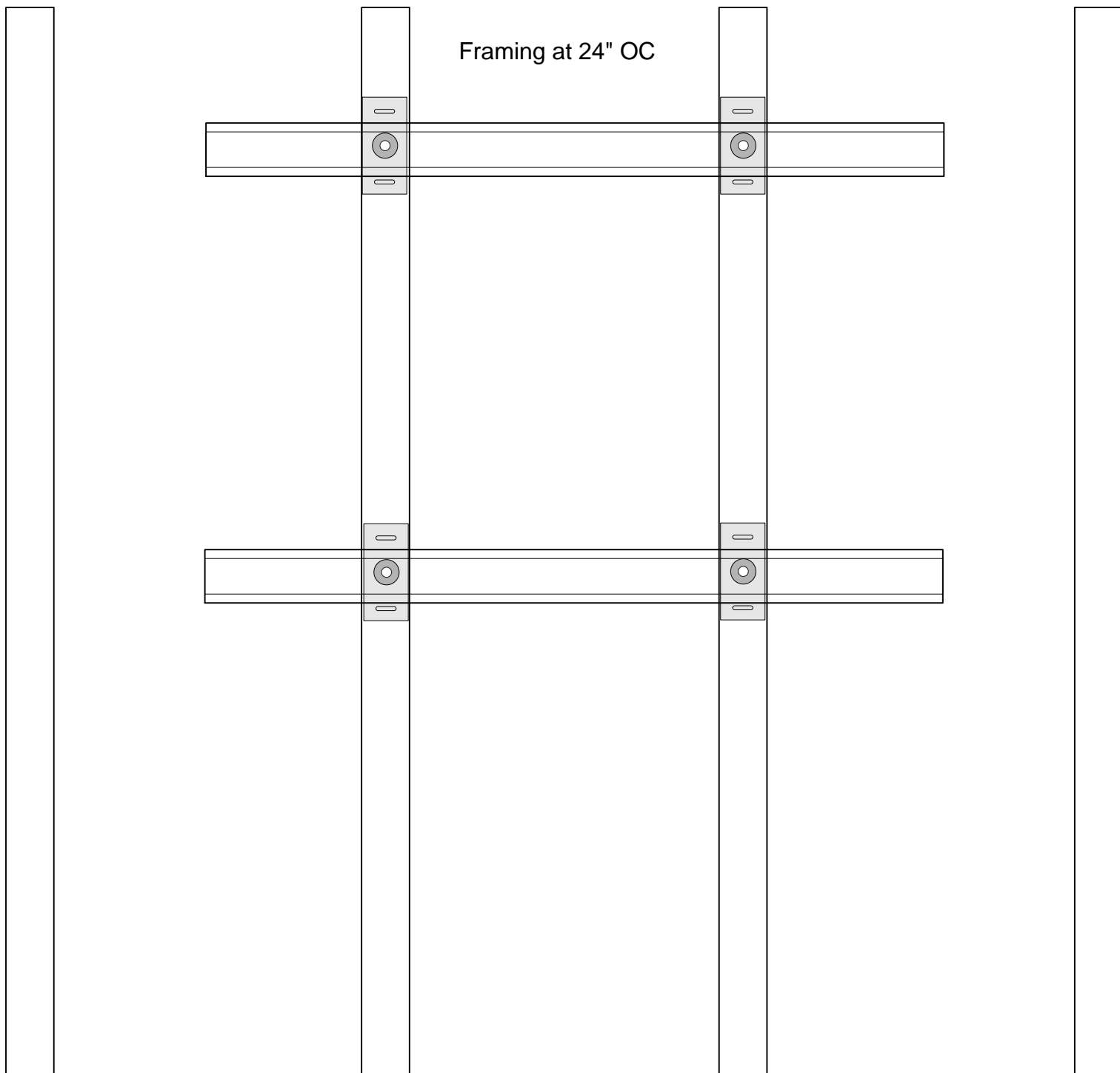

PAC International, Inc. RSIC-1 FS System Up to 37" (120 lb max)

Layout options

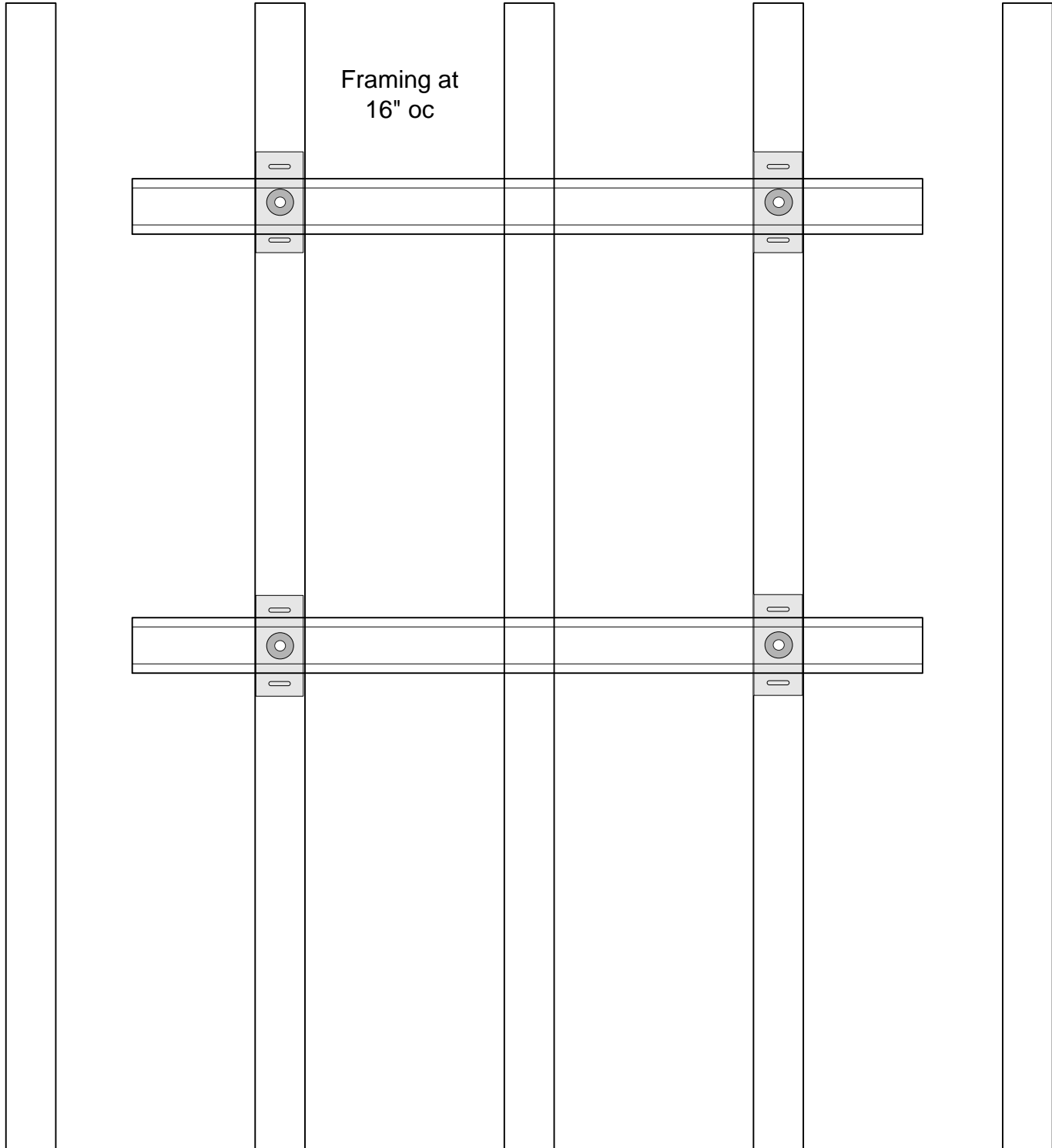

PAC International, Inc. RSIC-1 FS System Up to 37" (120 lb max)

Layout options

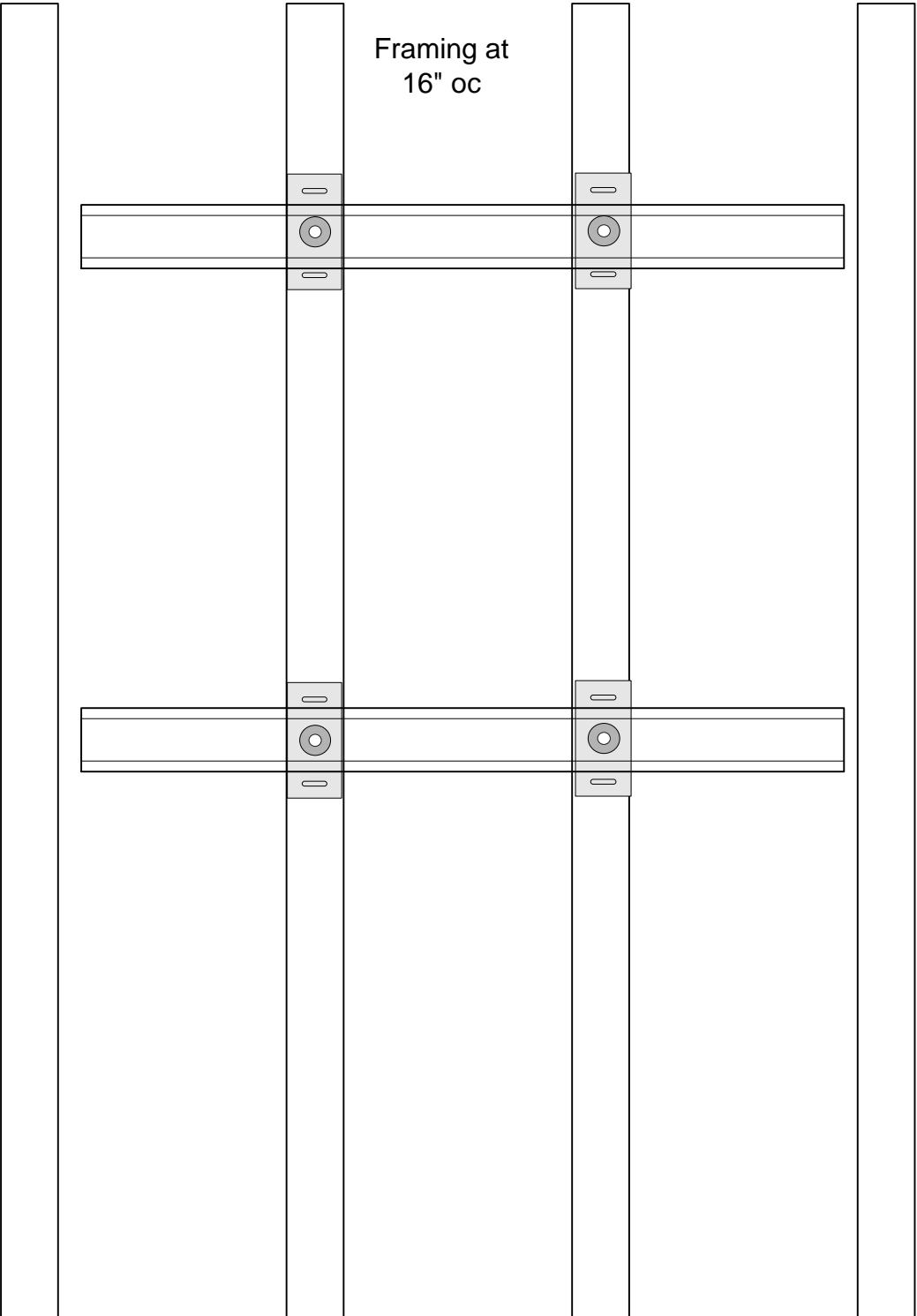

PAC International, Inc. RSIC-1 FS System 37" and Larger (200 lb max)

Safe Guard and Security Restraint

RSIC-Security
Strap

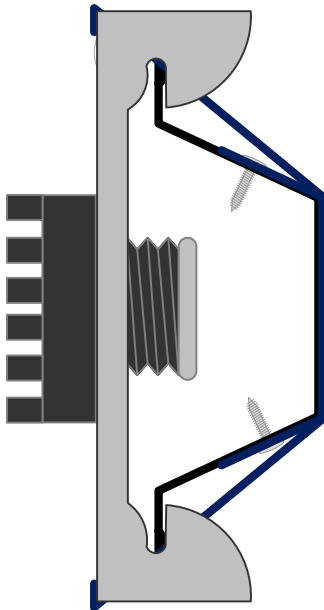
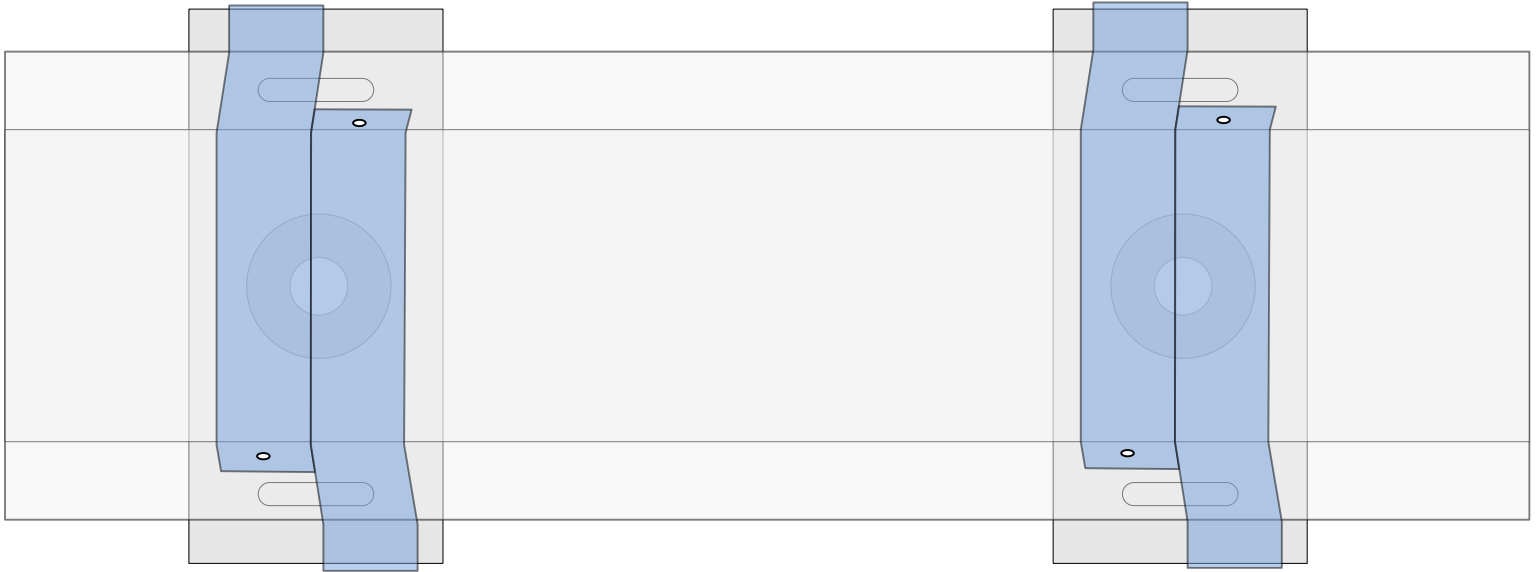

PAC International, Inc. RSIC-1 FS System

Less than 37" (120 lb max)

- Unpack RSIC-1 Flat Screen Wall Mount Isolation Kit (Confirm Parts Listed Below)
- Parts List.
 - * 4 Ea RSIC-1 Clips (for Heavy Duty Kit)
 - * 4 Ea RSIC-1 retro washers (1.5" x 1/4")
 - * 4 Ea 3-½" Coarse thread hex head mounting screws
 - * 8 Ea 7/16" Framing screws
 - * 8 Ea RSIC-Security Straps
 - * 12 Ea Super Screws (For Fastening Plywood to 7/8" Drywall Furring Channel to
- Locate desired position for Flat screen television
- Locate framing members behind Gypsum board
- Mark wall for location of RSIC-1 clips based on the size of the television. The RSIC-1 clips and drywall furring channel should be within 4 inches from the top and bottom. RSIC-1 clips should be spaced as wide as possible.
- Layout location of furring channel, and trim as needed to fit behind television.
- Materials Provided by others.(Plywood backing)
 - * Measure television for length and width. Length _____ Width _____
 - * Add min 3" to Length and Width then cut out Plywood to create a shield that is larger than the television.
 - * Optional Add trim to three sides of Plywood to hide RSIC Isolation system (Do not cover the top).
 - * Optional Finish Paint, stain, or cover plywood with fabric/carpet.
 - * Note: drill or cut a min 2 inch hole to run wiring through the plywood.
- Dry-fit system by laying the plywood with the trim pieces facing upward. Lay in drywall furring channel and make any final trimming of metal channel if required.
- Install the RSIC-1 clips to the wall with the retro washers between the clip and the gypsum board using the 3-½" screws provided in kit
- Snap each long sections (48" pieces) of drywall furring channel into RSIC-1 clips
- Install RSIC-Security Straps to the RSIC-1 clips and furring channel and secure with 7/16" steel framing screw. (See page 7)
- Screw the plywood to the Furring Channel. Use one screw every 6" (screw not provided by PAC International, Inc.) (Recommended 1-5/8" Fine thread fasteners)
- You may now install your flat screen mount "provided by others" to the Plywood shield. To center your television on the shield dry fit the mount onto the back of the television before mounting the bracket to the center of the plywood. Take measurements and transfer those measurements to the plywood shield to find the bracket location that centers the television on the plywood shield. (most mounting brackets are not designed to be centered behind the television.)
- Follow the directions for mounting your Television provided by the Flat screen wall mount bracket manufacturer.