

RSIC-1-EDGE SOUND ISOLATION CLIP

RSIC-1-EDGE INSTALLATION GUIDE

RSIC-1-EDGE



For use in conjunction with the RSIC-1 clip

PAC International, Inc. Tel: (866) 774-2100 Technical: (866) 649-2710 Web Site: www.pac-intl.com

© PAC International, LLC. All Rights Reserved. • (866) 774-2100 • Fax (866) 649-2710
RSIC® is a registered Trade Mark of PAC International, LLC.

RSIC-1-EDGE SOUND ISOLATION CLIP

RSIC-1-EDGE INSTALLATION GUIDE



Resilient Sound Isolation Clip (RSIC-1-EDGE)

- Spacing: maximum 48 inches on center
- Maximum acoustical design load: 18 lbs
- RSIC-EDGE is designed for use with the RSIC-1 clip is unable to be installed due to a lack of mounting surface.
- For example at the end of a furring channel run, or parallel to the joist at the wall ceiling intersection.

RSIC-1-PC dimensions:

- RSIC-1-EDGE clip 3" wide
- RSIC-1-EDGE clip 5-1/2" long
- RSIC-1-EDGE clip 1-1/2" deep



← 1-1/2" →



1"

Fasteners:

- RSIC-1-EDGE to wood: #8 x 1-1/2 inch minimum size coarse thread screw. (Recommended #10 or #12 x 1-1/2 inch hex head)
- RSIC-1-EDGE to Steel: # 8 x 1 inch minimum size fine thread screw. (Recommended #10 or #12 x 1/2 inch hex head)
- DO NOT fasten Resilient Sound Isolation Clips to framing members with nails. Use only approved screws.



Furring Channel:

- Recommended: 25 gauge, hemmed edge detail required on all 25 gauge furring channel. Meets or exceeds SSMA min. requirements.
- Depth: 7/8 inch
- Width Bottom: 2-9/16 to 2-11/16 inch wide minimum.
- Width Top: 1-1/4 inch wide
- Splice drywall furring channel (hat track) with 6 inch overlap in mid span (between two clip) secure with 18 Ga tie wire, or two 7/16" framing screws.

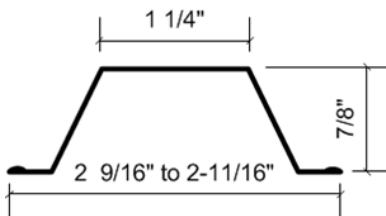

Average Labor Rates:

RSIC-1-EDGE: 60 clips per man hour

Drywall Furring Channel: 550LF per man hour

Labor rates provided to PAC International, Inc by independent contracting firm

PAC International, Inc. Tel: (866) 774-2100 Technical: (866) 649-2710 Web Site: www.pac-intl.com

© PAC International, LLC. All Rights Reserved. • (866) 774-2100 • Fax (866) 649-2710

RSIC® is a registered Trade Mark of PAC International, LLC.

RSIC-1-EDGE SOUND ISOLATION CLIP

RSIC-1-EDGE INSTALLATION GUIDE

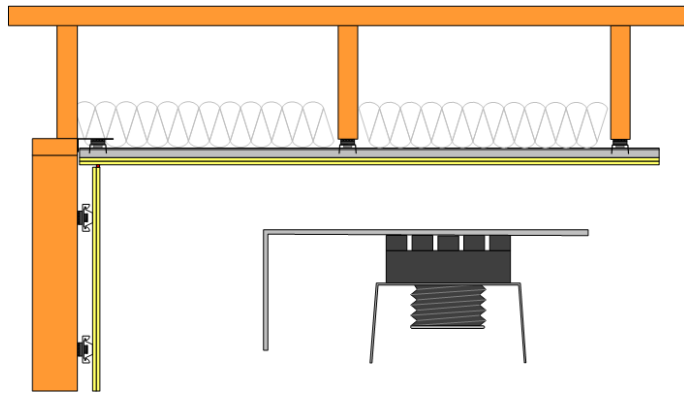

RSIC-1-EDGE

RSIC-1 EDGE Clip with down facing L bracket at perimeter where joist are not available for a standard RSIC-1 clip to be installed.

Ceilings: One and Two layer 5/8" gypsum

- Resilient Sound Isolation Clip (RSIC-1-EDGE) shall be 48 inches (1219mm) on center maximum. (Perpendicular to Joist/Truss)
- Fasten the Resilient Sound Isolation Clip (RSIC-1-EDGE) to the wall top plate ensuring the RSIC-1-Edge is in the same horizontal plane as the RSIC-1 clips fastened to the bottom of the joist.
- Ensure the metal "L" bracket is tight to the framing member.
- Snap in the drywall furring channel (hat track) into the RSIC-1-Edge clip (perpendicular or parallel) to the framing members.

General Information:

Resilient Sound Isolation Clip (RSIC-1-EDGE), Furring Channel (hat track) and Gypsum board shall not carry heavy loads such as cabinets or bookshelves

Splice furring channel (hat track) with 6 inch overlap in mid span, secure with 18 Ga. Tie wire or with two framing screws (7/16")

Seal all potential air leaks with non-hardening acoustical caulking to achieve best noise control results. Use fire rated sealant where required.

PAC International, Inc. Tel: (866) 774-2100 Technical: (866) 649-2710 Web Site: www.pac-intl.com

© PAC International, LLC. All Rights Reserved. • (866) 774-2100 • Fax (866) 649-2710
RSIC® is a registered Trade Mark of PAC International, LLC.

RSIC-1-EDGE SOUND ISOLATION CLIP

RSIC-1-EDGE INSTALLATION GUIDE

RSIC-1-EDGE Ceiling System Framing at 24" o.c.

RSIC-1 clips at 24" x 48" o.c. 1 or 2 Layers of 5/8" Gypsum Board

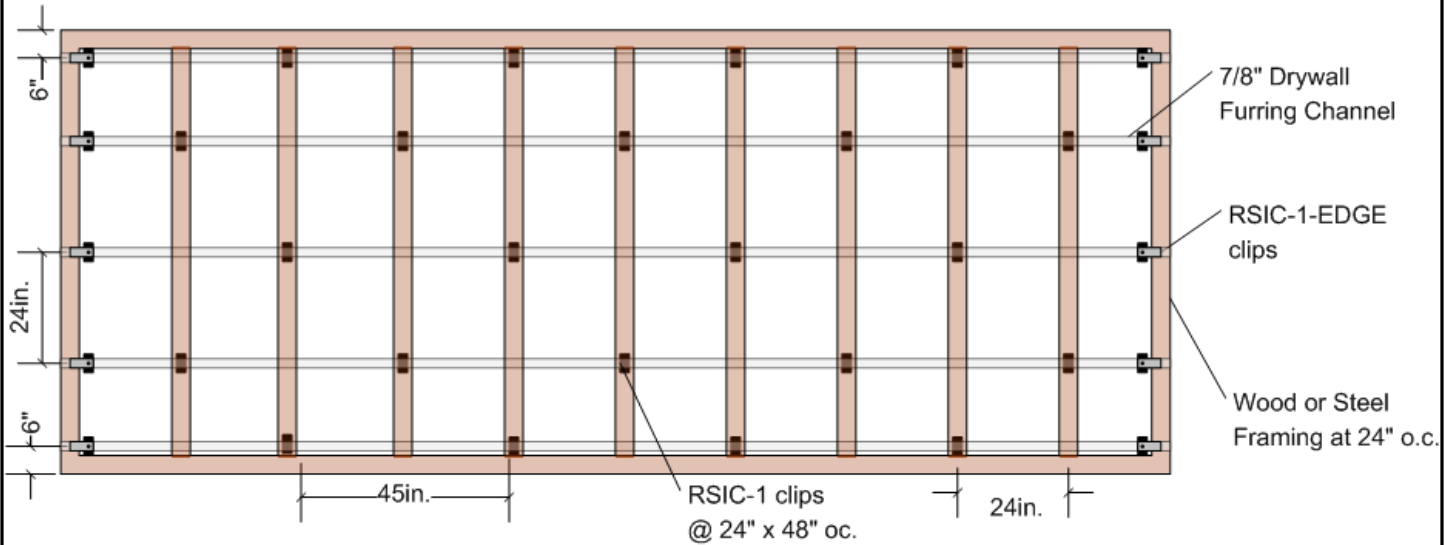

RSIC-1-EDGE Ceiling System Framing at 16" o.c.

RSIC-1 clips at 24" x 48" o.c. 1 or 2 Layers of 5/8" Gypsum Board

